

*The EUROPEAN
ASSOCIATION of
NEUROONCOLOGY*

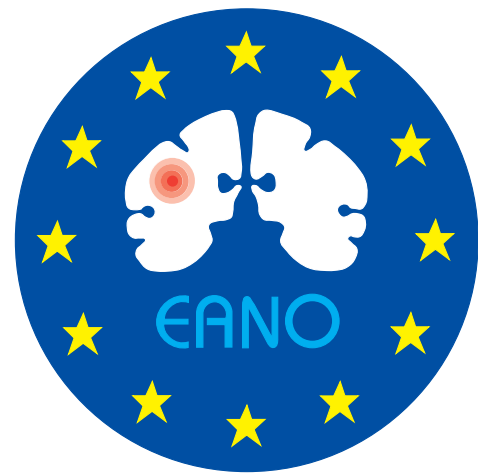

8th MEETING



2008

September 12-14

BARCELONA

PALAU DE CONGRESSOS DE CATALUNYA

FINAL PROGRAMME

www.eano.eu



Tumor cell
Tumor environment
Immune system

Merck Serono Oncology Symposium

Cilengitide – a first-in-class integrin inhibitor in the treatment of glioblastoma

September 11th, 2008

18:00 h – 19:00 h

Lecture Hall J

Palau de Congressos de Catalunya

Barcelona



Merck Serono Oncology | *Combination is key*

TABLE OF CONTENTS

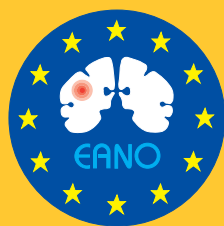

General

Committees, Boards	2
Welcoming Address	5
Floorplan of the Palau de Congressos de Catalunya	4
Overview Barcelona & Map	6
Acknowledgements – EANO 2010 – CME Credits	7
Programme at a Glance	8

Scientific Programme

- Thursday, September 11, 2008 (Postgraduate Course).....	9
- Friday, September 12, 2008	11
- Saturday, September 13, 2008	18
- Sunday, September 14, 2008.....	25
Meetings	27
Corporate Satellite Meetings	27
Poster Topics	28
Scientific Information	29

General Information

Social Events (Welcome Reception, EANO Evening)	30
General Information.....	31
Registration Fees	36

Exhibition

Exhibitors Standing	38
Exhibitors Listing	39

Printed in Austria by: ROBIDRUCK, 1200 Vienna – www.robidruck.co.at

E A N O 2 0 0 8

COMMITTEES - BOARD - ORGANISATION

EANO VIII Organising Committee

Ioannis Roussos, Congress President
Avelina Tortosa, Scientific Secretary
Javier Aristu
Carmen Balañá
José Piquer Belloch
Miguel Cerdá
Miguel Gil
Pedro Bilbao
José M^a de Campos
Juan Alvarez-Linera
Aurora Navajas
Gaspar Reynés
Teresa Ribalta
Mercedes Robledo
Manuel Santos
Eugenia Verger

EANO Executive Committee

Francesc Graus, President (E)
Robin Grant, Vice President (UK)
Albert Twijnstra, Treasurer (NL)
Bettina Müller, Secretary (D)
Carmine M. Carapella, Past President (I)
Shanne McNamara, Nurse Member (UK)
Susan Short (UK)
Andreas von Deimling (D)

EANO Secretariat

Mrs. Philomène Klomp
P.O. Box 219
5170 AE Kaatsheuvel
T: +31 416 54 00 37
F: +31 848398070
office@eano.eu
www.eano.eu

Conference Organisation, Abstract Management, Sponsoring

EANO 2008 Secretariat
c/o Vienna Medical Academy (VMA)
Mrs. Romana Koenig, Mrs. Marieke Hodel
Alser Strasse 4, A-1090 Vienna, Austria
T: +43 1 405 13 83 0
F: +43 1 407 82 74
eano2008@medacad.org
www.medacad.org

Exhibition and Advertisements

Medizinische Ausstellungs- und
Werbegesellschaft (MAW)
Mrs. May-Britt Ernst
Freyung 6
A-1010 Vienna, Austria
T: +43 1 536 63 - 75
F: +43 1 535 60 16
maw@media.co.at

Hotel Accommodation, Social Programme & Tours

Mondial & Cititravel Congressos, S.L.
Mrs. Gloria Casanova
C/. Rosselló 303, ático 1
08037 Barcelona, Spain
T: +34 93 221 -2955
F: +34 93 459 2059
eano2008@mondial-congress.com
www.mondial-congress.com

WELCOMING ADDRESS

Dear colleagues and friends,

It is our great pleasure to welcome you at the VIIIth Congress of the EANO in Barcelona from September 12 to 14, 2008 under the auspices of the Spanish Group of NeuroOncology (GENO).

GENO was founded in 1999 under the multidisciplinary spirit of EANO. The local organising committee has worked hard along with EANO to provide the best post-graduate course on the first day of the congress, and an attractive scientific programme that will cover the most important topics of our field in main symposia, meet-the-expert sessions and keynote lectures.

As usual, the interdisciplinary spirit will be the basis of the Congress. Colleagues from all neurooncological disciplines, such as basic sciences, neuropathology, neurology, neurosurgery, neuroimaging, medical, pediatric, and radiation oncology, and nurses are participating actively at the oral and poster presentations.

The congress takes place at the "Palau de Congressos de Catalunya" a modern, multipurpose building situated in a smart area of Barcelona. Barcelona is a modern multicultural city and the main exponent on the Catalan culture and heritage. The city is known worldwide for its architecture, cuisine, and most importantly, the way people from Barcelona enjoy life. We hope you will take, at least, a glimpse of all these wonders during the Congress.

**Welcome to Barcelona!
Bienvenidos a Barcelona!
Benvinguts a Barcelona!**



Ioannis Roussos
President, Organising Committee



Francesc Graus
President, EANO

Congress Venue

PALAU DE CONGRESSOS DE CATALUNYA

Av. Diagonal, 661-671

08028 Barcelona, Spain

T: +34 93 3644400 (during registration hours only)

www.pcongresos.com

WELCOMING ADDRESS

F L O O R P L A N

Palau de Congressos de Catalunya

FLOORPLAN LEVEL 0

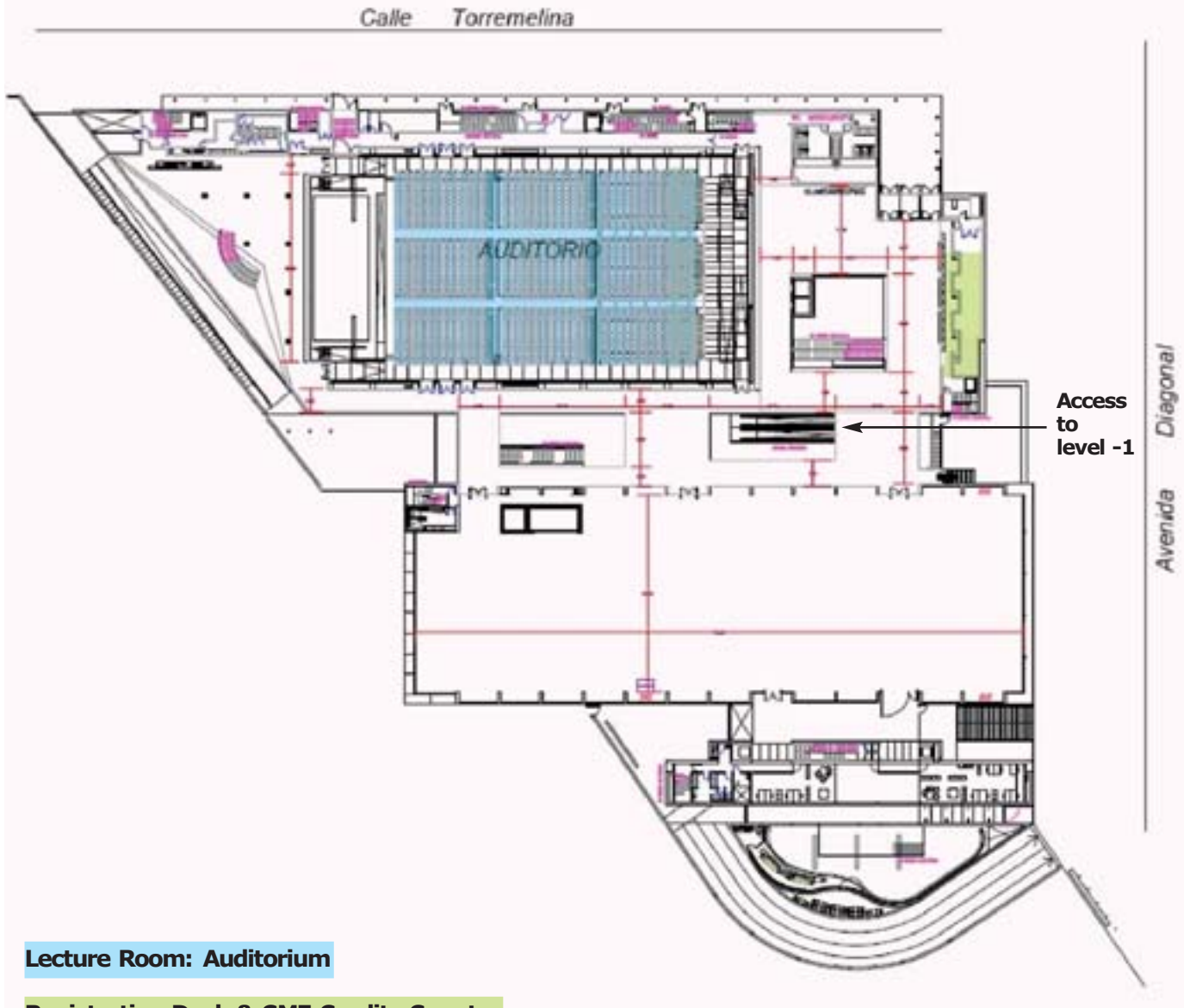

Lecture Room: Auditorium

Registration Desk & CME Credits Counter

Travel Agency Mondial & Cititravel Congressos, S.L.

EANO Association Booth

Wardrobe

Information Table

Message Board

F L O O R P L A N

Palau de Congressos de Catalunya

FLOORPLAN LEVEL -1

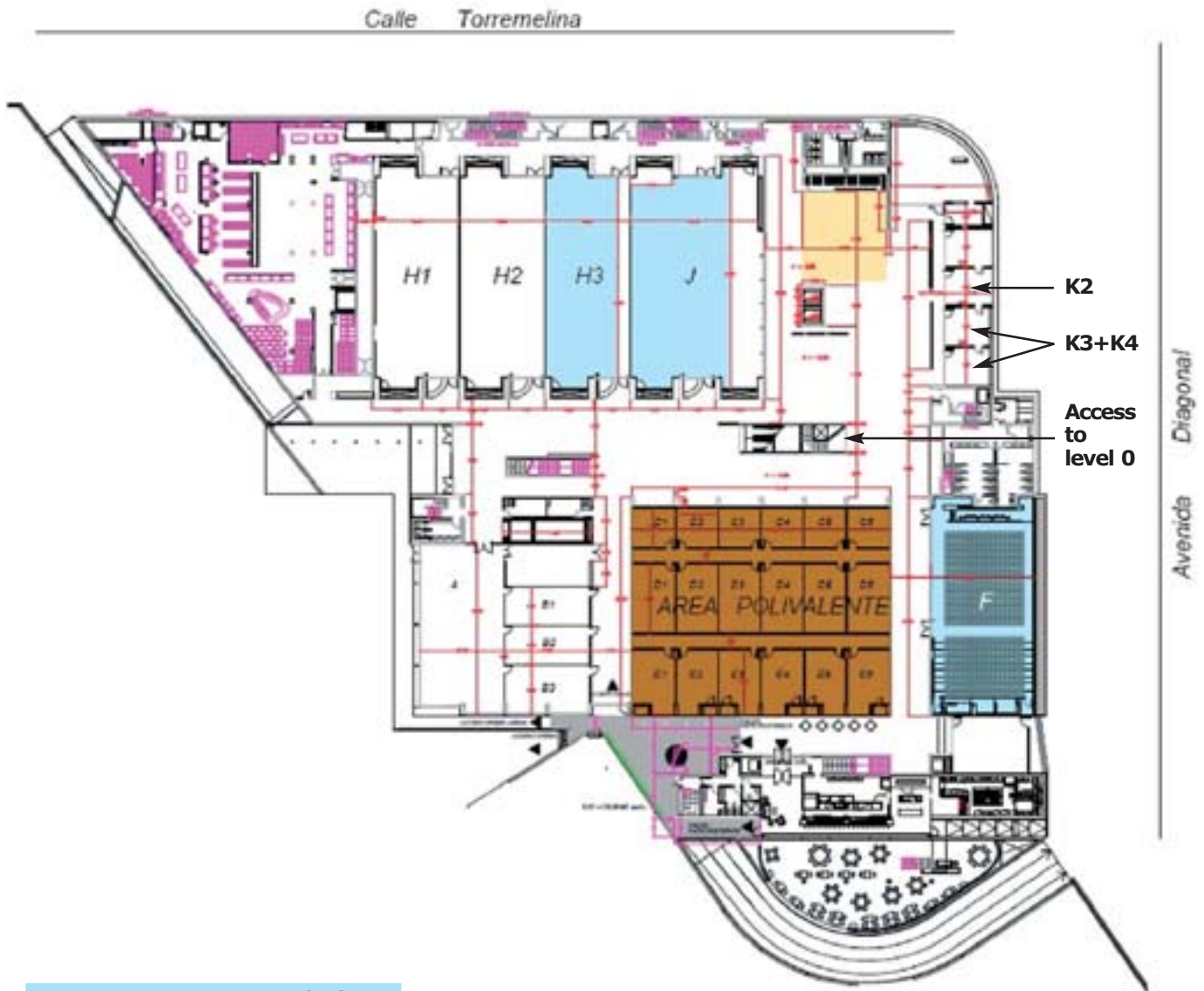

Lecture Rooms: Room/Sala J
Room/Sala F
Room/Sala H3

Preview Room: Room K3+K4

Meeting Room: Room K2

Internet Area

Poster/Coffee/Lunch/Exhibition Area

F L O O R P L A N

OVERVIEW BARCELONA & MAP

OVERVIEW BARCELONA & MAP



ACKNOWLEDGEMENTS

The European Association of NeuroOncology gratefully acknowledges the support of the following institutions, companies and organisations (list correct as per date of printing):

Platinum Sponsor:  Schering-Plough

Gold Sponsors: 



Silver Sponsor:  

Others: 

Future EANO Conference

9th Congress
European Association of NeuroOncology
September, 16-19, 2010
Maastricht, The Netherlands

CME Credits

The EANO has applied for credits at the European Accreditation Council for Continuing Medical Education, Institution of the UEMS. The number of credits (15 for the congress and 6 for the post-graduate course) will figure on the respective confirmation, which will be sent after the meeting.



The rules of the EACCME state that participants are kindly asked to fill in the feedback (evaluation) form included in the conference bag. It can be returned to the registration desk.

Participants applying for credits will have to have their badge scanned *daily* at the CME desk in the registration area before entering the conference. The confirmation will be mailed after the conference at the end of September.

Postgraduate Course: This activity has been accredited with 0,8 CME credits by the Catalan Council of Continuing Medical Education – Spanish Commission on Continuing Education of Health Professions equivalent to 6 learning hours.

Thursday, September 11, 2008 (Registration starts at 8.30)

Time	Room/Sala J	Room/Sala F
09.30–17.30	Postgraduate Course	10.00–16.30 HealthAgent Workshop
18.00–19.00	Satellite Symposium Merck Serono	
19.00–20.00	Welcome Reception in the beautiful garden of the Rey Juan Carlos I	

Friday, September 12, 2008

Time	Auditorium	Room/Sala J	Room/Sala F
08.00–09.00	Meet The Experts Sessions	Meet The Experts Sessions	Meet The Experts Sessions
09.10–10.10	01 Malignant glioma second line treatments (I)	02 Surgery of gliomas	03 Experimental models of targeted therapies
10.15–11.15	04 Malignant glioma: second line treatments (II)	05 Low grade gliomas	06 Non glial tumors
11.15–11.45	Coffee break		
11.45–12.00	Official Opening of the Congress		
12.00–13.30	Plenary Session: Targeted therapy in gliomas		
13.30–14.30	Lunch / Poster / Exhibition	14.00–18.00 Nurses Session Room/Sala H3	
14.30–15.30	Poster Viewing in the Poster/Exhibition Area		
15.30–16.30	Presentation selected posters	Presentation selected posters	Presentation selected posters
16.30–17.00	Coffee break		
17.00–18.00	Keynote Lecture: Genes that mediate brain metastases		
18.00–19.30	Satellite Symposium Schering-Plough		

Saturday, September 13, 2008

Time	Auditorium	Room/Sala J	Room/Sala F
08.00–09.00	Meet The Experts Sessions	Meet The Experts Sessions	Meet The Experts Sessions
09.10–10.10	07 Glioblastoma multiforme (I)	08 Cell signaling and biomolecular markers	09 Neurological complications of systemic cancer
10.15–11.15	10 Glioblastoma multiforme (II)	11 Prognostic factors in brain tumors	12 Quality of life studies
11.15–11.45	Coffee break		
11.45–13.15	Plenary Session: Molecular pathways in brain tumors		
13.15–14.00	Lunch / Poster / Exhibition		
14.00–15.00	Poster Viewing in the Poster/Exhibition Area		
15.00–16.00	Presentation selected posters	Presentation selected posters	Presentation selected posters
16.00–16.30	Coffee break		
16.30–17.30	Keynote Lecture: Clinical relevance of glioma typing and grading according to the WHO		
17.30–18.00	EANO General Assembly		
18.10–19.10	Satellite Symposium Ark Therapeutics (from 17.40 Cocktail in Foyer of Auditorium)		
20.30–23.00	EANO VIII Evening at the royal shipyards MARQUES DE COMILLAS – DRASSANES REIALS DE BARCELONA		

Sunday, September 14, 2008

Time	Auditorium
09.00–11.00	Plenary Session: Neurological complications of cancer
11.00–11.30	Coffee break
11.30–12.00	Special Lecture: Ongoing clinical trials in brain tumors
12.00–13.00	Keynote Lecture: How not to misinterpret data from clinical trials
13.00–13.30	Communication Awards & Closing Remarks

SCIENTIFIC PROGRAMME

Time	Room/Sala J	Room/Sala F
	Postgraduate Course	10.00-16.00 HealthAgents Workshop
09.30-11.00	1. CANCER STEM CELLS AND TUMOR THERAPEUTIC RESISTANCE Chair: A. Tortosa (Barcelona, Spain) Stem cells and the origin of gliomas, <i>R. Galli (Stem Cell Research Institute, Milano, Italy)</i> Regulation of glioma stem cell self-renewal, <i>J. Seoane (Vall d'Hebron Univ. Hospital Research Institute, Barcelona, Spain)</i> Cancer stem cells and tumor resistance to treatment, <i>A. Tortosa (Escola Universitària d'Infermeria, Universitat de Barcelona, Spain)</i>	(a satellite event of a non profit organization interested in brain tumor research) Please note: EANO is not responsible for the contents. More information on www.healthagents.net/workshop
11.00-11.30	Coffee break	
11.30-13.00	2. MALIGNANT GLIOMAS: REVIEW OF LOCAL THERAPIES Chair: J. Piquer (Alzira, Spain) Fluorescence - guided resection of malignant gliomas, <i>W. Stummer (University of Dusseldorf, Germany)</i> Drug delivery systems for brain tumor therapy <i>C. Carapella (Regina Elena National Cancer Institute, Roma, Italy)</i> Impact of new radiotherapy techniques in the treatment of malignant gliomas, <i>M. Santos (Clinica Benidorm, Alicante, Spain)</i>	
13.00-14.00	Lunch	
14.00-15.30	3. UPDATE IN MEDULLOBLASTOMAS Chair: A. Navajas (Bilbao, Spain) Incidence and survival of Medulloblastoma, <i>R. Peris (Spanish National Childhood Cancer Registries, University of Valencia, Spain)</i> Biological markers in Medulloblastoma - Prognostic value of molecular abnormalities, <i>D. Ellison (Northern Institute for Cancer Research, Newcastle-upon-Tyne, UK)</i> Stratification of treatment in medulloblastomas based on prognostic factors, Radiotherapy, <i>J. Giral (Hospital Universitary Vall d'Hebron, Barcelona, Spain)</i> Chemotherapy, <i>A. Navajas (Pediatric Oncology Unit Hospital, Cruces, Bilbao, Spain)</i>	
15.30-16.00	Coffee break	
16.00-17.30	4. NEW IMAGING TOOLS IN THE MANAGEMENT OF BRAIN TUMORS Chair: J. Alvarez-Linera (Madrid, Spain) Diffusion weighted and perfusion MR techniques in the evaluation of brain tumors, <i>J. Alvarez-Linera (Hospital Ruber Internacional, Madrid, Spain)</i> MR spectroscopy in the diagnosis and follow-up of malignant gliomas, <i>R. Agatti (Hospedal Belarla, Bologna, Italy)</i> Role of positron emission tomography (PET) in the evaluation of gliomas, <i>H. Engler (Uppsala University, Sweden)</i>	

THURSDAY, SEPTEMBER 11

SCIENTIFIC PROGRAMME

Time

Room/Sala J

18.00-
19.00

Satellite Symposium Merck Serono

Cilengitide – the first integrin inhibitor in the treatment of glioblastoma multiforme

Chair: M. van den Bent, M. Weller

Welcome and Introduction, *M. Weller*

Current treatment methods in glioblastoma multiforme, *D. Reardon*

Cilengitide – a first-in-class integrin inhibitor, *J.C. Tonn*

CENTRIC – a phase III study of cilengitide in GBM, *R. Stupp*

Discussion and closing remarks, *M. van den Bent*

19.00-20.00 EANO Welcome Reception

in the beautiful garden of the Rey Juan Carlos I, located half way between the hotel Rey Juan Carlos I and the EANO VIII Congress venue, the Palau de Congressos.

Free for registered participants and accompanying persons.

**Please note that advance registration is mandatory in order to receive a ticket!
Limited attendance!**

SCIENTIFIC PROGRAMME

Time	Room/Sala H3
	Nurses Session EANO VIII
14.00	Introduction, S. McNamara (United Kingdom)
14.10	Health Related Quality of Life versus Survival: at what cost?, M. Taphoorn (<i>The Netherlands</i>)
14.45	Electronic Clinical Pathways in Neuro-Oncology, L. Braam (<i>The Netherlands</i>)
15.15	Social Aspects in Patients with Glioma, G. Jobst (<i>Austria</i>)
15.45- 16.15	Coffee break
16.15	Temozolomide and Implications for Interventions by the Nurse Practitioner in Neuro-Oncology, H. Zwinkels (<i>The Netherlands</i>)
16.45	The management of Malignant Spinal Cord compression - striving for consensus, L. Kilbride (<i>United Kingdom</i>)
17.15	Neuro-cognitive functioning in glioma patients, M. Klein (<i>The Netherlands</i>)
17.45	Closing remarks

FRIDAY, SEPTEMBER 12

SCIENTIFIC PROGRAMME

FRIDAY, SEPTEMBER 12

Time	Auditorium	Room/Sala J	Room/Sala F
8.00-9.00	<p>Meet The Experts Sessions: Gene therapy for brain tumors Chair: J. Fueyo (USA) Speakers: J. Fueyo (Houston, USA) R. Alemany (Hospitalet, Spain)</p>	<p>Meet The Experts Sessions: Supportive care in brain tumors Chair: B. Muller (Germany) Speakers: B. Muller (Kreischa, Germany) S. McNamara (Edinburgh, UK)</p>	<p>Meet The Experts Sessions: Primary brain lymphomas Chair: U. Schlegel (Germany) Speakers: U. Schlegel (Bochum, Germany) K. Hoang Xuan (Paris, France)</p>
Time	Auditorium	Room/Sala J	Room/Sala F
09.10 - 10.10	<p>Session: 01 Malignant glioma: second line treatments (I) Chair: A.Brandes (Italy), M.Gil (Spain)</p> <p>001 Bevacizumab (B) plus irinotecan (I) in progressive temozolomide (T) refractory glioblastoma multiforme (GBM): a single center experience using a low dose regimen G. Dresemann, A. Dresemann, A. Hobbold</p> <p>002 Evaluation of the early antiangiogenic activity of Sunitinib malate by perfusion CBF and CBV values from DSC-based perfusion in recurrent glioblastoma C. Chaskis, M. Dujardin, A. Michotte, B. Neyns</p> <p>003 Tegwondo - development of a novel near-continuous dose-dense temozolomide regimen for the treatment of recurrent gliomas H. M. Strik, J. H. Buhk, C. Bock, M. Nitsche, A. L. Hoffmann, A. Wrede, C. Marosi, U. Kaiser, M. Christmann, B. Kaina</p> <p>004 The Temozolomide RESCUE study: A Phase II trial of continuous (28/28) dose-intense temozolomide (TMZ) after progression on conventional 5/28 day TMZ in patients with recurrent malignant glioma J. Perry, W. Mason, K. Belanger, P. Kavan, D. Fulton, J. Easaw, S. Kirby, D. Macdonald, C. Shields, J. F. Pouliot</p> <p>005 Therapeutic efficacy and toxicity of local (Gliadel® wafer) and systemic intensified chemotherapy one week on/one week off in recurrent gliomas after surgical resection C. Ewelt, J. Schroeteler, W. Stummer, J. Felsberg, H. Steiger, M. Sabel</p> <p>006 A phase II multicentric trial of fotemustine (FTM) in patients (pts) with recurrent/progressive glioblastoma after radiotherapy plus concomitant and/or adjuvant temozolomide : a GICNO (Gruppo Italiano Cooperativo di Neuro-Oncologia) study A. A. Brandes, A. Tosoni, E. Franceschi, E. Mazza, A. Santoro, M. Faedi, R. Labianca, R. Bertorelle, T. Perrone, E. Pesenti</p>	<p>Session: 02 Surgery of gliomas Chair: C.Carapella (Italy), H.Duffau (France)</p> <p>007 Multimodal preoperative MR-imaging in patients with presumed low grade gliomas in eloquent language areas - implications for targeted surgical resection R. Gerlach, E. Hattingen, K. Franz, T. Gasser, I. Kropf, A. Szelenyi, V. Seifert</p> <p>008 Combined use of DTI FT and intraoperative subcortical mapping for surgical removal of gliomas L. Bello, A. Castellano, G. Bertani, A. Gambini, A. Casarotti, A. Falini</p> <p>009 Surgery of insular WHO grade II gliomas: A consecutive series of 52 patients H. Duffau</p> <p>010 The impact of resection in the treatment of glioblastoma multiforme: Survival comparison with the RTOG recursive partitioning analysis of ALA glioma study patients W. Stummer, U. Pichlmeier, G. Schackert</p> <p>011 Combined use of tractography-integrated functional neuro-navigation and 5-ALA fluorescence navigation during resection of glioblastoma multiforme involving pyramidal tract K. Sato, T. Ito, M. Oikawa, H. Nakamura</p> <p>012 Surgery guided by 5ala fluorescence is a safe and efficient method with the potential for greatly increase the rate of gross total resection in glioblastoma R. Diez Valle, S. Tejada Solis, M. Idoate Gastearena</p>	<p>Session: 03 Experimental models of targeted therapies Chair: R.Galli (Italy), J.Seoane (Spain)</p> <p>013 CpG-oligonucleotides are superior to other TLR-ligands in the local treatment of established intracerebral murine gliomas O. M. Grauer, J. W. Molling, R. P. M. Suttmuller, S. Nierkens, G. J. Adema</p> <p>014 Inhibition of diffusely invasive glioblastoma growth in vivo by targeting EGFR but not VEGFR-2 K. Lamszus, T. Martens, Y. Laabs, H. Günther, L. Witte, M. Westphal</p> <p>015 Differentiation therapy exerts anti-tumorigenic, anti-angiogenic, anti-invasive and proapoptotic effects in brain tumor stem cell-derived tumors B. Campos, F. Wan, F. Zeppernick, R. Ahmadi, M. Farhadi, W. Roth, P. Beckhove, A. Unterberg, B. Radlwimmer, C. Herold-Mende</p> <p>016 Antiangiogenic treatment reduces tumor vasculature and tumor cell infiltration in a glioma cancer stem cell model in nude mice L. Bello, C. Verpelli, G. Bertani, G. Casaceli, V. Lucini, R. Galli, C. Sala</p> <p>017 Tumor specific migration of bone-marrow derived rat mesenchymal stem cells in the invasive N29 rat brain tumor model D. Bexell, S. Gunnarsson, A. Tormin, D. Gisselsson, S. Scheding, J. Bengzon,</p> <p>018 In vitro investigation of Varizella Zoster Virus as an oncolytic virus in glioblastoma therapy N. Thon, H. Leske, C. Schichor, J. Tonn, R. Goldbrunner, A. Baiker</p>

SCIENTIFIC PROGRAMME

Time	Auditorium	Room/Sala J	Room/Sala F
10.15 - 11.15	<p>Session: 04 Malignant glioma: second line treatments (II) Chair: M.Brada (United Kingdom), W.Wick (Germany)</p> <p>O19 A multicenter stratified phase II study of cetuximab for the treatment of patients with recurrent high-grade glioma B. Neyns, J. Sadones, E. Joosens, F. Bouttens, L. Verbeke, J. Baurain, L. Dhondt, T. Strauven, C. Chaskis, A. Michotte</p> <p>O20 Phase II study of antineoplastic A10 and AS2-1 infusions (ANP) in patients with recurrent anaplastic astrocytoma S. R. Burzynski, R. Weaver, T. Janicki, B. Szymkowski, M. Walczak, G. Burzynski</p> <p>O21 A randomised trial of procarbazine, CCNU and vincristine (PCV) vs temozolomide (5-day or 21-day schedule) for recurrent high grade glioma (Medical Research Council Trial BR12, ISRCTN83176944) M. Brada for the BR collaborators</p> <p>O22 Enzastaurin (ENZ) versus lomustine (CCNU) in the treatment of recurrent, intracranial glioblastoma (GBM): A phase III study W. Wick, V. K. Puduvalli, M. Chamberlain, A. Carpentier, L. Cher, W. Mason, M. Van den Bent, S. Hong, D. Thornton, H. Fine</p> <p>O23 Targeted therapy with AP 12009 for recurrent or refractory high-grade glioma: results update of a Phase IIb study U. Bogdahn, A. K. Mahapatra, V. E. Oliushine, C. Mouli, V. E. Parfenov, G. Stockhammer, S. Ludwig, G. Wuerth, H. Heinrichs, K. H. Schlingensiepen</p> <p>O24 Phase I of high dose temozolomide (HDTMZ) with peripheral blood stem cell support (PBSCS) rescue in recurrent high grade glioma (HGG) D. Frappaz, S. Dussart, J. Pierga, J. Bay, M. Fabbro, L. Djafari, M. Sunyach</p>	<p>Session: 05 Low grade gliomas Chair: J.Rees (United Kingdom), O.Cruz (Spain)</p> <p>O25 Targeting the BRAF oncogene in pediatric low-grade astrocytomas S. M. Pfister, W. Janzarik, M. Remke, A. Ernst, A. Gnekow, G. Reifenberger, W. Scheurlen, H. Omran, A. Kulozik, P. Lichter</p> <p>O26 MGMT promoter Hypermethylation in low grade Astrocytomas M. Eoli, A. Di Stefano, L. Valletta, S. Guzzetti, D. Bianchessi, B. Pollo, A. Silvani, M. Bruzzone, A. Boiardi, G. Broggi, G. Finocchiaro</p> <p>O27 Protracted low dose Temozolomide (TMZ) as initial treatment for progressive low grade oligodendroglial tumors: a phase II AINO (Italian Association for Neuro-Oncology) study E. Trevisan, E. Laguzzi, D. Guarneri, C. Bompreszi, M. Caroli, B. Leoncini, R. Soffietti, R. Rudà</p> <p>O28 Tumour growth rate predicts transformation-free survival in adult low-grade gliomas J. H. Rees, J. S. Winston, R. Jager, C. Benton, G. Brasil Caseiras, P. S. Tofts, D. Altmann, D. Tozer, A. D. Waldman,</p> <p>O29 Low grade astrocytoma in children: single institutional experience in 143 patients O. Cruz, N. Perez, E. Rodriguez, M. Suñol, V. Cusi, C. De Torres, G. Garcia-Fructuoso, A. Guillen, A. Parareda, J. Mora</p> <p>O30 Temozolomide in primary gliomatosis cerebri: final results of a retrospective study of the AINO (Italian Association for Neuro-Oncology) R. Rudà, E. Laguzzi, A. Pace, C. M. Carapella, M. Riva, M. Salvati, A. Silvani, L. Fariselli, M. Caroli, R. Soffietti</p>	<p>Session: 06 Non glial tumors Chair: A.Omuro (France), A.Navajas (Spain)</p> <p>O31 Degree of Blood-Brain Barrier Disruption and Cumulative Total Dose Intensity in the Treatment of Primary Central Nervous System Lymphoma D. F. Kraemer, L. Angelov, N. D. Doolittle, T. Siegal, D. Peereboom, K. Jahnke, E. Shalom, G. Barnett, J. McGregor, E. A. Neuwelt</p> <p>O32 Methotrexate, procarbazine and CCNU as chemotherapy-only treatment for primary central nervous system lymphoma in young patients: a French Neuro-Oncology Association (ANOCEF) study A. M. P. Omuro, L. Taillandier, O. Chinot, C. Carnin, M. Barrié, C. Soussain, M. Tanguy, M. Sierra Del Rio, V. Leblond, K. Hoang-Xuan</p> <p>O33 Early radiographic response to chemotherapy predicts favorable outcome in patients with primary CNS lymphoma H. Pels, A. Juergens, I. Schirgens, A. Glasmacher, H. Schulz, A. Engert, V. Diehl, M. Linnebank, G. Schackert, H. Reichmann, F. Kroschinsky, M. Vogt-Schaden, G. Egerer, U. Bode, M. Deckert, R. Fimmers, K. Fließbach, T. Klockgether, I. G. H. Schmidt-Wolf</p> <p>O34 Primary Pineal Tumors. Outcome and prognostic factors. A study from the Rare Cancer Network (RCN) S. Villà, R. Miller, M. Krengli, H. Abusaris, B. O. Baumert, S. Servagi-Vernat, S. Igdem, A. Lucas, S. Boluda, R. O. Mirimanoff</p> <p>O35 Metastatic medulloblastoma Chang staging system revised C. Dufour, J. Micheli, A. Fourcade, A. Laplanche, C. Kalifa, D. Couanet, J. Grill</p> <p>O36 Atypical teratoid/rhabdoid tumors (AT/RTs) in the pediatric population of Austria: a population-based study, 1996 – 2006 A. Woehrer, T. Waldhoer, A. Azizi, I. Leisser, T. Czech, H. Budka, J. A. Hainfellner, I. Slavc, C. Haberler, A. W. on behalf of the Austrian Brain Tumour Registry</p>
11.15 - 11.45	Coffee break		

FRIDAY, SEPTEMBER 12

SCIENTIFIC PROGRAMME

FRIDAY, SEPTEMBER 12

Time	Auditorium
11.45-12.00	<p>Official Opening of EANO VIII Chair: F. Graus (Barcelona, Spain) Welcoming addresses by Francesc Graus, President EANO, Ioannis Roussos, President EANO 2008, and Baltasar Porcel, writer and brain tumor patient</p>
12.00-13.30	<p>Plenary Session: Targeted therapy in gliomas Chair: R. Stupp (Lausanne, Switzerland)</p> <p>Biological rational of targeting signaling pathways and angiogenesis with radiotherapy, M. Pruschy (Zurich, Switzerland) Promises and pitfalls of local therapy in glioma, Z. Ram (Tel Aviv, Israel) Strategies of integration of molecular targets and antiangiogenic treatments in clinical trials of glioma, R. Stupp (Lausanne, Switzerland)</p>
13.30-14.30	<i>Lunch / Poster viewing / Exhibition</i>
Time	Room / Sala H3
14.00-18.00	Nurses Session (programme see page 11)
14.30-15.30	<p>Poster viewing with presenters TOPICS:</p> <p>Pediatric brain tumors P001–P010 Primary brain tumors: Miscellanea. P011–P028 Neurosurgical topics P029–P044 Meningiomas P045–P054 Malignant glioma: second line therapies. P055–P065 Neuroimaging P066–P084 Predictive biomolecular markers (I). P085–P100 Stem cells P101–P111 Cell biology and signalling P112–P133</p>

SCIENTIFIC PROGRAMME

Time	Auditorium	Room/Sala J	Room/Sala F
15.30 - 16.30	<p>Presentation Selected Posters Session: 13 Neurosurgical topics Neuroimaging/meningiomas Chair: L. Bello (Italy), J. Piquer (Spain)</p> <p>P032 Supratentorial ventricular tumors- a surgical perspective S. I. Florian, C. I. Abrudan, A. Oslobanu, Z. Andrasoni</p> <p>P042 Cerebral plasticity: new acquisitions gained from functional mapping of lesions in eloquent areas and their prognostic and therapeutic implications. F. Signorelli, L. De Geronimo, J. Guyotat</p> <p>P044 Pleomorphic Xanthoastrocytoma - Long-term results of surgical treatment of 34 cases P. Gallo, P. C. Cecchi, C. Ghimenton, N. Schiavo, G. Pinna, C. Mazza, M. Gerosa, S. Turazzi</p> <p>P045 Radiological surveillance following surgery for supratentorial meningioma: how often and for how long? A. Hassani, D. Scoones, N. Bradey, P. J. Kane</p> <p>P046 Long term growth pattern of meningiomas S. Nakasu, Y. Nakasu, T. Fukami, J. Jito</p> <p>P049 Parasagittal location as a bad prognosis factor in terms of recurrence and tumoral control for meningiomas. J. Villard, A. Pica, J. Bloch</p> <p>P069 Relative value of magnetic resonance spectroscopy, magnetic resonance perfusion, and 2-(18f)fluoro-2-deoxy-d-glucose positron emission tomography for detection of recurrence or grade increase in gliomas I. Galeano, R. Prat, A. Lucas, J. Martínez, M. Martín, R. Conde, R. Amador, L. Bataller, G. Reyes</p> <p>P073 Thallium SPECT imaging of supratentorial primary brain tumours: How useful is it in routine clinical practice? A. D. Kane, N. Brady, M. Richardson, D. Scoones, I. R. Chambers, P. J. Kane</p> <p>P075 Usefulness of F-DOPA PET in the differentiation of recurrent glioma from radiation necrosis F. Payer, W. Wurm, S. Weiss, B. Zechner, F. Fazekas</p>	<p>Presentation Selected Posters Session: 14 Stem cells/molecular markers/ cell biology Chair: T. Siegal (Israel), T. Ribalta (Spain)</p> <p>P117 Analysis of GATA-6 Expression in Progression From Low Grade Glioma to Secondary Glioblastoma G. Carrabba, S. Agnithori, D. Munoz, S. Ehsani, D. Mukhopadhyay, S. Croul, A. Guha</p> <p>P107 Identification of cancer stem cells in a mouse model of medulloblastoma and molecular comparison with normal neural stem cells D. Corno, B. Cipelletti, M. Pala, L. Politi, A. Bulfone, R. Galli</p> <p>P111 EGFR expression identifies distinct populations of glioblastoma multiforme cancer stem cells with different tumorigenic potential S. Mazzoleni, L. Politi, M. De Palma, R. Galli</p> <p>P118 Similarities and deviations in microRNA signature of glial tumors, embryonic stem cells and neuronal progenitor cells I. Lavon, D. Zrihan, M. A. Cohen, B. Reubinoff, O. Einstein, T. Ben-Hur, Y. Smith, T. Siegal</p> <p>P116 Comparative study of gene expression and protein expression profiling in gliomas O. Persson, U. Brynnel, F. Levander, B. Widegren, M. Krogh, L. G. Salford</p> <p>P114 Mutational profiling of the Glioblastoma Multiforme kinome F. E. Bleeker, S. Lamba, C. Zanon, D. Troost, T. J. Hulsebos, W. P. Vandertop, S. Leenstra, A. A. Van Tilborg, A. Bardelli</p> <p>P102 Risk potential of autologous mesenchymal stem cell transplantation in glioblastoma patients C. Schichor, E. Soballa, J. Tonn, R. H. Goldbrunner</p> <p>P101 N29 and N32 rat glioma models exhibit cancer stem cell properties S. Gunnarsson, D. Bexell, E. Visse, L. G. Salford, P. Siesjö, J. Bengzon, A. Darabi</p>	<p>Presentation Selected Posters Session: 15 Pediatric brain tumors/Malignant glioma: second line treatments/Miscellanea Chair: S. Pfister (Germany), B. Baumert (The Netherlands)</p> <p>P001 Hyperfractionated Accelerated Radiotherapy (HART) with Chemotherapy for Metastatic Medulloblastoma (MB): Preliminary report of the Children's Cancer and Leukaemia Group (CCLG) Study R. E. Taylor, N. Boota, S. Bujkiewicz, J. Lucas, K. J. Robinson, K. Robson, F. Saran, A. Michalski, B. Pizer</p> <p>P002 Sequential high-dose chemotherapy and reduced craniospinal irradiation in young children with metastatic medulloblastoma C. Dufour, D. Couanet, D. Figarella-Branger, C. Carrie, F. Doz, C. Sainte-Rose, M. Raquin, A. Laplanche, J. Grill, C. Kalifa</p> <p>P003 Medulloblastomas: clinicopathologic review of 51 patients and disclosure of unsuspected AT/RT M. Suñol, O. Cruz, E. Rodriguez, V. Cusí, A. Guillen, M. Medina, N. Perez, J. Mora</p> <p>P007 Clinical and radiological correlation in children with newly diagnosed intrinsic brain stem gliomas treated with concurrent and adjuvant Temozolomide with radiotherapy: data from a prospective clinical trial R. Jalali, N. Raut, T. Gupta, B. Arora, P. Kurkure, D. Dutta, R. Sarin</p> <p>P011 Long-Term Survivors of a Systemic and Intraventricular Chemotherapy With Deferred Radiotherapy in Primary Central Nervous System Lymphoma A. Juergens, H. Pels, S. Rogowski, H. Schulz, H. Reichmann, M. Vogt-Schaden, I. G. H. Schmidt-Wolf, U. Schlegel</p> <p>P055 Nimustine (ACNU) plus teniposide (VM26) in recurrent glioblastoma M. Glas, T. Hundsberger, M. Stuplich, D. Wiewrodt, D. Kurzweilly, B. Nguyen-Huu, K. Rasch, U. Herrlinger</p> <p>P056 Combination of bevacizumab and irinotecan for recurrent malignant gliomas: a retrospective study of efficacy and safety M. Martínez García, G. Reyes, C. Balaña, C. Fernandez Chacon, M. Benavides, P. Perez Segura, A. Herrero, A. Garcia Velasco, X. Perez Martin, M. Gil Gil</p> <p>P061 Rechallenge With Temozolomide in Recurrent Gliomas A. Wick, C. Pascher, W. Wick, M. Weller, U. Bogdahn, P. Hau</p> <p>P015 "Nitrosourea-based chemotherapy for low grade gliomas failing initial treatment with temozolomide." M. A. Sierra del Rio, G. Kaloshi, F. Ducray, A. Idbaih, F. Laigle-Donadey, S. Taillibert, A. Omuro, M. Sanson, J. Y. Delattre, K. Hoang-Xuan</p>
16.30 - 17.00	Coffee break		

FRIDAY, SEPTEMBER 12

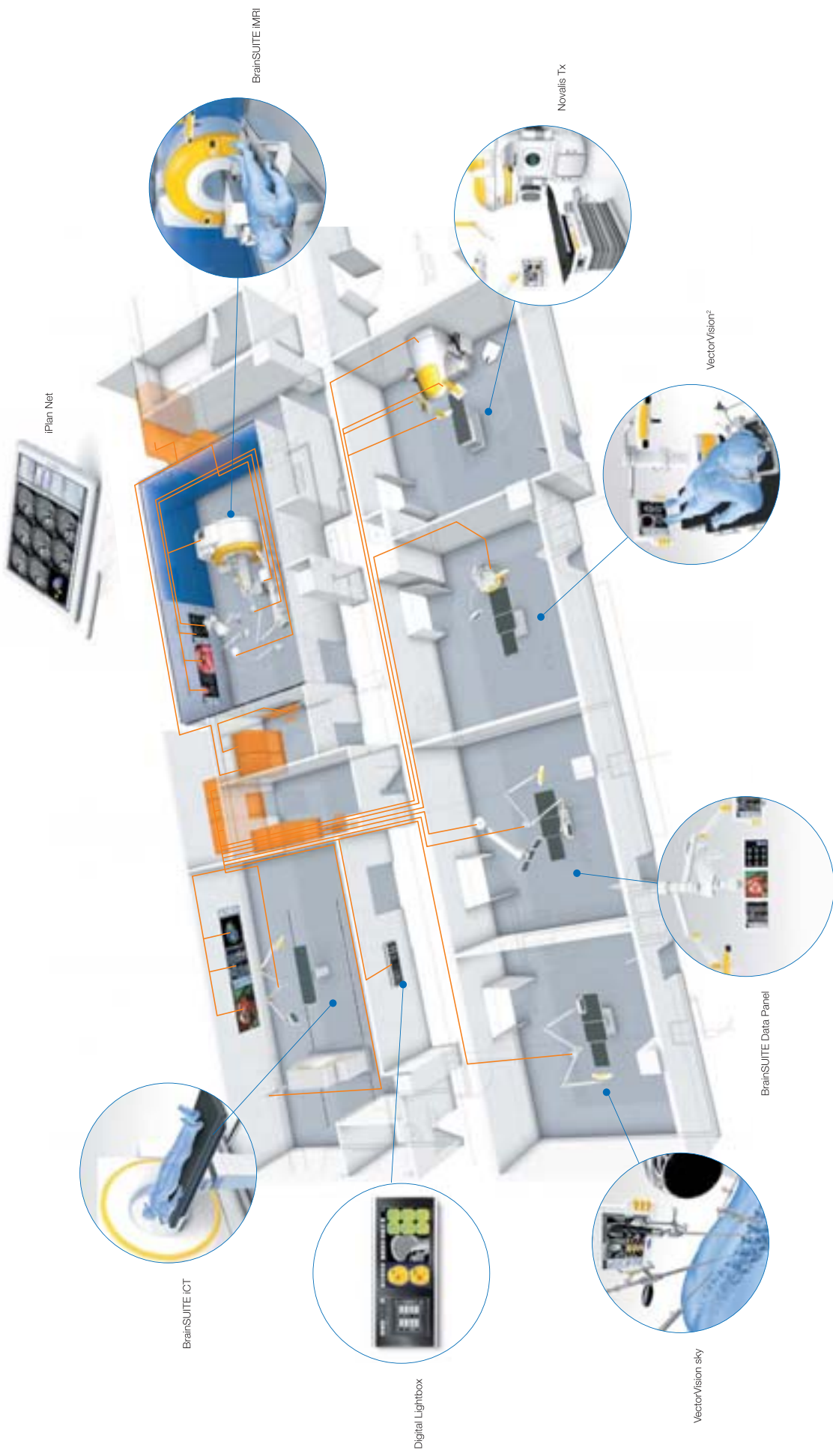

Integrated Neuroscience

Bringing all aspects of treatment under one roof...unlocking possibilities

SCIENTIFIC PROGRAMME

Time	Auditorium
17.00-18.00	<p>Keynote Lecture Chair: F. Graus (Barcelona, Spain)</p> <p>Genes that mediate brain metastases, J. Massagué (New York, USA)</p>
Time	Auditorium
18.00-19.30	<p>Satellite Symposium Schering Plough Pharmaceuticals</p> <p>Neuro-Oncology 2008: Are we having more answers or more questions? Chair: M. van den Bent, D. den Hoed</p> <p>Welcome and Introductions, <i>M. van den Bent</i></p> <p>Presentation of NOA-4: Randomized Phase III Study of Sequential Radiochemotherapy of Anaplastic Glioma with PCV or Temozolomide, <i>W. Wick</i></p> <p>Pathology Review in Clinical Trials: Mandatory or Many-Headed Monster? <i>M. van den Bent, D. den Hoed</i></p> <p>The Troublesome Diagnosis of Anaplastic (WHO Grade III) Glioma: The EORTC Experience, <i>J. M. Kros</i></p> <p>Applying MGMT Assessment: A Critical Assessment of Various Methods, <i>M. Weller</i></p> <p>Question and Answer Session Faculty Panel</p>

FRIDAY, SEPTEMBER 12

SCIENTIFIC PROGRAMME

SATURDAY, SEPTEMBER 13

Time	Auditorium	Room/Sala J	Room/Sala F
8.00-9.00	<p>Meet The Experts Sessions: Pitfalls in the diagnosis of brain tumors Chair: A. Omuro (France) Speakers: A. Omuro (Paris, France), D. Zagzag (New York, USA) <i>This session is kindly supported by Schering Plough.</i></p>	<p>Meet The Experts Sessions: Glioma stem cells and therapeutic resistance Chair: A. Tortosa (Spain) Speakers: R. Galli (Milano, Italy), J. Seoane (Barcelona, Spain) <i>This session is kindly supported by Eli Lilly.</i></p>	<p>Meet The Experts Sessions: Controversies in the treatment of single brain metastasis Chair: S. Villà (Spain) Speakers: D. C. Weber (Geneva, Switzerland), J. Wolbers (Rotterdam, The Netherlands)</p>
Time	Auditorium	Room/Sala J	Room/Sala F
09.10 - 10.10	<p>Session: 07 Glioblastoma multiforme (I) Chair: M. Van den Bent (The Netherlands), C. Balaña (Spain)</p> <p>037 Early treatment related necrosis is associated with prolonged survival in malignant gliomas A. M. Demopoulos, <i>B. A. Napolitano, D. Chalif, K. Black</i></p> <p>038 Impact of extent of resection and outcome to adjuvant chemotherapy. A meta-analysis of three EORTC studies M. J. van den Bent, R. Stupp, <i>J. Hildebrand, A. A. Brandes, R. Mirimanoff, W. Mason, M. Weller, J. G. Cairncross, J. Delattre, D. Lacombe, T. Gorlia</i></p> <p>039 Hypofractionated radiotherapy with Intensity Modulated Arc Therapy (IMAT) plus adjuvant temozolomide for primary glioblastoma multiforme N. D'Abbio, A. Pisanello, G. De Berti, C. Iotti, T. Palmieri, <i>D. Ramundo, M. Galeandro, M. Ruggieri, S. Riccardi, D. Lambertini, N. Bizzocchi, R. Ghadirpour, L. Armaroli, N. Marcello</i></p> <p>040 Prospective randomized study comparing first-line nitrosourea-based chemotherapy versus radiotherapy alone in non resectable glioblastomas in adult M. Frenay, J. Simon, <i>L. Benboubker, L. Taillandier, D. Castera, M. Campone, A. Busson, F. Berger, C. Lebrun</i></p> <p>041 Phase I/II Study of Enzastaurin (ENZ) plus Temozolomide (TMZ) and Radiation Therapy (XRT) in Patients (Pts) with Glioblastoma Multiforme (GBM) or Gliosarcoma (GS) N. Butowski, K. Lamborn, <i>S. Chang, M. Page, R. Parvataneni, S. Chang, A. M. Liepa, S. Nicol, D. Thornton, M. Prados</i></p> <p>042 Radiochemotherapy with daily concomitant and adjuvant one week on/one week off temozolomide plus indomethacin in newly diagnosed glioblastoma: a phase II trial M. Weiler, C. Hartmann, <i>D. Wiewrodt, U. Herrlinger, M. Bamberg, A. von Deimling, M. Weller, W. Wick</i></p>	<p>Session: 08 Cell signaling and biomolecular markers Chair: A. Von Deimling (Germany), M. Robledo (Spain)</p> <p>043 The topography of cellular malignancy in human glioblastoma M. Glas, B. H. Ley, A. Leinhaas, <i>R. Eisenreich, B. Steinfarz, J. Schramm, M. Simon, U. Herrlinger, O. Brüstle, B. Scheffler</i></p> <p>044 Identification of relevant markers for the classification and grading of diffusely infiltrative gliomas Y. Ruano, T. Ribalta, A. Rodríguez de Lope, C. Fiaño, E. Pérez-Magán, <i>J. Hernández-Moneo, Y. Campos-Martín, J. García, M. Mollejo, B. Meléndez</i></p> <p>045 Conversion of astrocytes into progenitor-like cells upon Transforming Growth Factor alpha (TG-Falpha) exposure sensitizes them to cancerous transformation C. Dufour, J. Cadusseau, P. Varlet, <i>N. Auger, E. Daudigeos, P. Rodier, A. Dias-Morais, G. Vassal, H. Chneiweiss, M. Junier</i></p> <p>046 The response of Human Glioma cells to Temozolomide and Irradiation: Relationship with MGMT promotor methylation and protein expression P. Sminia, K. A. van Nifterik, <i>J. van den Berg, N. Ameziane, T. J. M. Hulsebos, S. Leenstra, L. Wedekind, M. V. M. Lafleur, L. J. A. Stalpers, B. J. Slotman</i></p> <p>047 Temozolomide induces selective depletion of cancer stem cells in human glioblastomas D. Beier, S. Röhl, D. R. Pillai, <i>S. Schwarz, L. Kunz-Schughart, M. Proescholdt, A. Brawanski, U. Bogdahn, J. Wischhusen, G. Reifenberger, P. Hau, C. P. Beier</i></p> <p>048 Concordance between serum DNA and tumor DNA in detection of genetic-epigenetic aberrations of glial tumors I. Lavon, M. Raphael, <i>J. Goldmann, B. Zelikovitch, T. Siegal</i></p>	<p>Session: 09 Neurological complications of systemic cancer Chair: R. Soffietti (Italy), S. Villà (Spain)</p> <p>049 Increased risk of stroke and transient ischemic attack (TIA) in 5-year survivors of Hodgkin's Lymphoma L. D. Dorresteijn, M. L. De Bruin, <i>M. B. van 't Veer, E. M. Noordijk, H. van den Berg, B. M. Aleman, A. C. Kappelle, W. Boogerd, F. E. van Leeuwen</i></p> <p>050 Optic neuropathy in patients with malignant gliomas treated with bevacizumab J. H. Sherman, D. G. Aregawi, <i>A. Lai, S. S. Rosenfeld, H. M. Fathallah-Shaykh, J. M. Larner, S. A. Newman, D. Schiff</i></p> <p>051 Comparison of the retrospective and prospective BSBM system's classification with a 6 years follow up for patients with brain metastases treated by Leksell Gamma Knife radiosurgery D. Devriendt, F. De Smedt, <i>P. David, N. Massager</i></p> <p>052 Impact of Surgical Excision Methodology on the Incidence of Local Recurrence in Patients with Single Brain Metastasis (SBM) Who Have Not Received Adjuvant Whole Brain Radiation Therapy (AWBRT) D. Suki, A. J. Patel, <i>M. A. Hatiboglu, H. Abou-Assi, R. Sawaya</i></p> <p>053 Differential impact of whole brain radiotherapy added to radiosurgery for the RPA class I or II brain metastases D. Kong, J. Lee, Y. Im, D. Nam, <i>K. Park, J. Kim</i></p> <p>054 Phase II trial of patupilone in patients with breast cancer brain metastases D. M. Peereboom, A. K. Conlin, <i>A. D. Seidman, C. Brewer</i></p>

SCIENTIFIC PROGRAMME

Time	Auditorium	Room/Sala J	Room/Sala F
10.15 - 11.15	<p>Session: 10 Glioblastoma multi-forme (II) Chair: L. Salford (Sweden), J. De Campos (Spain)</p> <p>O55 Molecular stereotactic biopsies in gliomas - a prospective one-year experience C. A. Eroes, N. Thon, E. Grasbon-Frodl, G. Poepperl, J. Tonn, F. Kreth</p> <p>O56 Integration of metabolic imaging and molecular genetic profiling of serial stereotactic biopsies are valuable for histological discrimination of oligodendrogliomas, mixed oligoastrocytomas and astrocytomas WHO II/III N. Thon, C. Erös, G. Pöpperl, J. Herms, J. Tonn, F. Kreth</p> <p>O57 Primary Glioblastoma treated with Boron Neutron Capture Therapy - Evaluation of a prolonged high dose of boronophenylalanine (BPA) R. Henriksson, J. Capala, A. Michanek, S. Lindahl, L. G. Salford, L. Franzén, E. Blomquist, J. Westlin, T. A. Bergenheim</p> <p>O58 Survival benefit from Boron Neutron Capture Therapy for the newly diagnosed glioblastoma patients N. Nonoguchi, S. Kawabata, S. Miyatake, K. Iida, S. Miyata, K. Yokoyama, T. Kuroiwa, M. Kirihaata, Y. Imahori, K. Ono</p> <p>O59 Immunotherapy of glioblastoma with autologous dendritic cells M. Rapp, M. Rapp, Z. Özcan, J. Fischer, J. Rox, R. Sorg</p> <p>O60 Imaging and dosimetry of convection enhanced delivery of Cotara (131I-<i>chTNT-1/B Mab</i>) in patients with recurrent glioblastoma K. D. Judy, R. Lustig, J. Lopinto, S. Shen, J. Fiveash, J. Shan</p>	<p>Session: 11 Prognostic factors in brain tumors Chair: M. Preusser (Austria), A. Tortosa (Spain)</p> <p>O61 Recursive partitioning analysis of prognostic factors in WHO grade III glioma patients treated with radiotherapy or radiotherapy plus chemotherapy C. Park, S. Lee, C. Kim, D. Kim, S. Paek, D. Kim, D. Heo, I. Kim, H. Jung</p> <p>O62 Quantitative, PCR-based MGMT-methylation analysis in glioblastoma multiforme L. Mariani, L. Anderegg, M. Arnold, I. Vajtai, E. Vassella</p> <p>O63 Prognostic and predictive significance of MGMT promoter methylation and protein expression in glioblastoma patients S. Spiegl-Kreinecker, C. Pirker, M. Filipits, D. Lötsch, J. Buchroithner, J. Pichler, R. Silye, M. Micksche, J. Fischer, W. Berger</p> <p>O64 Anti-MGMT immunohistochemistry in EORTC/NCIC trial 26981/22981: observer variability, lack of association with MGMT promoter methylation status and patient survival impede its use as clinical biomarker in glioblastoma multiforme. A translational research M. Preusser, R. C. Janzer, J. Felsberg, G. Reifenberger, R. Stupp, T. Gorlia, C. Marosi, H. Heinzl, J. A. Hainfellner, M. Hegi,</p> <p>O65 Association between immunohistochemical tissue inhibitor of metalloproteinases-1 (TIMP-1) score and patient survival in gliomas C. Aaberg-Jessen, K. Christensen, H. D. Schröder, H. Offenberg, N. Brünner, B. W. Kristensen</p> <p>O66 Prognostic significance of NDRG2 promoter hypermethylation in atypical and anaplastic meningiomas A. Tortosa, J. Bruna, P. Roerig, F. Martínez, M. Riemenschneider, S. Boluda, P. Giménez-Bonafé, G. Reifenberger</p>	<p>Session: 12 Quality of life studies Chair: R. Grant (United Kingdom), E. Verger (Spain)</p> <p>O67 Health-related quality of life of long-term surviving high-grade glioma patients I. Bosma, J. C. Reijneveld, L. Douw, M. J. Vos, T. J. Postma, W. P. Vandertop, B. J. Slotman, M. J. B. Taphoorn, J. J. Heimans, M. Klein</p> <p>O68 Cognitive rehabilitation of glioma patients: The results of a prospective, randomized study K. Gehring, N. K. Aaronson, M. M. Sitskoorn, M. Klein, T. J. Postma, M. J. van den Bent, G. N. Beute, R. H. Enting, A. C. Kappelle, W. Boogerd, T. Veninga, A. Twijnstra, D. H. Boerman, M. J. B. Taphoorn,</p> <p>O69 Survey on the hormonal system and fertility in women of reproductive age after receiving therapy for malignant glioma WHO III or IV K. Elandt, C. Kurz, M. Hassler, U. Dieckmann, A. Rottenfusser, C. Marosi</p> <p>O70 Attitudes to diagnosing and treating depression in glioma: a questionnaire survey of five specialties A. G. Rooney, A. Carson, I. R. Whittle, S. Erridge, R. Grant</p> <p>O71 Endocrine function after craniospinal irradiation for medulloblastoma in children and adults. S. Beltran, M. El Rawas, M. Sunyach, P. Berlier, C. Conter, F. Borson-Chazot, D. Frappaz</p> <p>O72 The impact of cognitive deficits and epilepsy on quality of life in meningioma patients after treatment. M. L. Waagemans, M. Dijkstra, D. van Nieuwenhuizen, M. Wumkes, C. M. F. Dirven, J. C. Reijneveld, M. Klein, L. J. A. Stalpers</p>
11.15 - 11.45	Coffee break		

SATURDAY, SEPTEMBER 13

SCIENTIFIC PROGRAMME

SATURDAY, SEPTEMBER 13

Time	Auditorium
11.45-13.15	<p>Plenary Session: Molecular pathways in brain tumors Chair: H. Ohgaki (Lyon, France)</p> <p>Molecular genetics of astrocytic tumours, H. Ohgaki (Lyon, France) Molecular genetics of oligodendrogliomas and mixed gliomas, G. Reifenberger (Dusseldorf, Germany) Molecular genetics of medulloblastomas and PNETs, D. Ellison (Newcastle-upon-Tyne, UK)</p>
13.15-14.00	<i>Lunch / Poster viewing / Exhibition</i>
14.00-15.00	<p>Poster viewing with presenters TOPICS:</p> <p>CNS metastases P134-145 Non-metastatic complications. P146-156 Quality of life / Palliative care. P157-170 Malignant gliomas: up-front treatments. P171-182 Predictive biomolecular markers (II) P183-199 Tumoral immunology. P200-205 Neuropathology P206-219 Epidemiology/clinical series and case reports P220-278</p>

SCIENTIFIC PROGRAMME

Time	Auditorium	Room/Sala J	Room/Sala F
15.00-16.00	<p>Presentation Selected Posters Session: 16 Biomolecular markers/malignant gliomas/quality of life/palliative care Chair: K. Hoang Xuan (France), G. Reynes (Spain)</p> <p>P183 MGMT Immunoeexpression in Progressive Non-Functioning Pituitary Adenomas: Potential Candidates for Treatment with Temozolomide? G. Widhalm, S. Wolfsberger, M. Preusser, A. Wöhrer, M. Kotter, T. Czech, C. Marosi, E. Knosp</p> <p>P190 Promoter hypermethylation, Western blotting analysis and immunohistochemistry of MGMT in a series of 101 glioblastomas M. Mellai, A. Chiò, M. Lanotte, P. Cassoni, V. Caldera, L. Annovazzi, G. Finocchiaro, D. Schiffer</p> <p>P186 Correlation of genomic and epigenomic changes with survival in glioblastoma multiforme P. M. J. Clement, A. Wozniak, H. De Schutter, J. Menten, R. Sciot, F. Van Calenbergh, C. Stefan, M. Debiec-Rychter</p> <p>P171 Phase II study of fixed-dose rate (FDR) gemcitabine as a radiosensitizer for newly diagnosed glioblastoma multiforme (GBM) A. Fabi, A. M. Mirri, G. Metro, A. Felici, A. Vidiri, A. Pace, M. A. Carosi, F. Cognetti, E. M. Occhipinti, C. M. Carapella</p> <p>P172 A phase 2 study of multimodal therapy with surgery, carmustine (BCNU) wafer, radiation therapy (RT), and temozolomide (TMZ) in patients (pts) with newly diagnosed supratentorial malignant glioma (MG) R. La Rocca, T. W. Vitaz, W. Villanueva, J. Hodes, A. Cervera, P. New, N. Litofsky, N. Litofsky</p> <p>P178 Phase I trial of arsenic trioxide and temozolomide in combination with radiation therapy for patients with high grade gliomas. S. A. Grimm, M. Marymont, J. Chandler, K. Muro, S. Newman, R. Levy, L. Rice, K. Burns, C. Cabreza, J. Raizer</p> <p>P167 Evaluation of late toxicity in adult patients treated for medulloblastoma M. M. Sunyach, C. Christian, F. Didier</p> <p>P168 HADS mood screening in neuro-oncology radiotherapy patients N. B. Detert, C. Blesing, N. Warner, V. Russell</p> <p>P161 Neuropsychological and quality of life factors as predictors of survival in patients with glioma A. Bellver-Pérez, G. Reynes Muntaner, B. Espejo Tort, M. Martín Ureste, J. Montalar Salcedo</p>	<p>Presentation Selected Posters Session: 17 Epidemiology/CNS metastases Chair: W. Grisold (Austria), P. Bilbao (Spain)</p> <p>P134 Leptomeningeal carcinomatosis. Prognostic implications of clinical and cerebrospinal fluid features in 70 patients J. Bruna, L. González, J. Miró, R. Velasco, M. Gil, A. Tortosa</p> <p>P138 Stereotactic Radiosurgery by Helical Tomotherapy System for Metastatic Brain Tumors Using 11C-methionine PET S. Takenaka, K. Miwa, J. Shinoda, M. Matsuo, T. Ueda, K. Yokoyama, J. Yamada, H. Yano, T. Iwama</p> <p>P140 Brain metastases and radiosurgery : 6 years follow up comparing the RPA , SIR and BSBM patients stratification systems D. Devriendt, F. De Smedt, P. David, N. Massager</p> <p>P223 WHO Grade II-III glioma diagnosed before 2000 reclassified in the light of new classification according Immuno-Histo-Chemistry and imaging: a retrospective study of 129 patients. M. Fabbro, A. Maran, V. Rigau, L. Bauchet, H. Duffau, P. Peray, V. Costes</p> <p>P224 The impact of changes in pathological classification and referral patterns on treatment and outcome of patients diagnosed with a glioma 1988-2002 S. C. Erridge, G. R. Kerr, M. Hart, S. McNamara, C. Smith, R. Grant, I. Whittle, A. Gregor,</p> <p>P225 Intracranial tumors in a cohort of Neurofibromatosis I patients J. M. de Campos, M. E. Kusak, C. J. Klein, J. Ayerbe, A. del Villar, J. L. Sarasa</p> <p>P229 The glioblastoma multiforme of the elderly: the prognostic impact of resection on survival M. Goepfert, W. Stummer, H. Steiger, M. Sabel</p> <p>P237 Quantifying assessments for glioblastoma multiforme (GBM) for clinical trails - an alternative approach G. Dresemann, G. Sorenson, D. A. Reardon, C. Hosius, R. Parker, Z. Nikolova</p> <p>P232 Biodegradable carmustine-impregnated wafers (Gliadel®): the French experience P. Menei, P. Metellus, H. Loiseau, L. Capelle, G. Jacquet, J. Guyotat and the club of neuro-oncology of the FSN</p>	<p>Presentation Selected Posters Session: 18 Tumor invasion/angiogenesis/in-vitro, in-vivo models Chair: S. Short (United Kingdom), M. Weller (Switzerland)</p> <p>P260 The influence of Rad51 mediated repair on treatment resistance in high grade gliomas S. C. Short, C. Martindale, M. Worku, S. Bourne</p> <p>P246 Anti-angiogenic compounds cause vessel normalization in gliomas. A. Claes, C. Maass, J. W. Jeuken, W. P. Leenders, P. Wesseling</p> <p>P268 Targeted delivery to primary brain tumors using liposomes M. Bellavance, F. Gobeil, D. Fortin</p> <p>P259 Erucylphosphohomocholine-induced cell death in human glioma cells: Role of the 18 kDa Translocator protein and the ANT2 isoform of the adenine nucleotide transporter W. Kugler, P. Hülper, M. Lakomek, M. Gavish, L. Veenman</p> <p>P272 Autocrine and paracrine contributions of FGF5 to the malignant progression of human astrocytic brain tumors S. Allerstorfer, C. Pirker, S. Spiegel-Kreinecker, J. Pichler, J. Buchroithner, M. Grusch, R. Silye, J. Fischer, M. Micksche, W. Berger</p> <p>P249 Escape from anti-angiogenic therapy? Phenotypic changes induced by anti-VEGF treatment S. J. Grau, J. Thorsteinsdottir, F. Winkler, L. von Baumgarten, J. Tonn, R. H. Goldbrunner</p> <p>P253 Glioma-cell migration on myelinated axons in vitro P. Oellers, V. Senner, W. Paulus, S. Thanos</p> <p>P214 Towards brain tumour classification by molecular profiling: Imaging, metabolomic and genomic tools B. Celda, D. Monleon, J. Piquer, J. Llacer, A. Revet, E. Molla, M. Martinez-Bisbal</p> <p>P278 Circulating adult human mesenchymal stem cells contribute to neoangiogenesis in malignant gliomas C. Schichor, I. Teichert von Luettichau, B. Krebs, S. Grau, J. Herms, J. Tonn, P. Nelson, R. H. Goldbrunner</p>
16.00 - 16.30	Coffee break		

SATURDAY, SEPTEMBER 13



Every door opened could be a discovery made.

Lilly Oncology is a proud sponsor of
The European Association of NeuroOncology

Lilly Oncology

No two cancer patients are alike. That's why Lilly Oncology is committed to developing treatment approaches as individual as the people who need them. We've made many contributions toward improved patient outcomes and—with each door we open—we take another step forward. But helping today's cancer patient isn't enough. Even with over 40 drug targets in development, our quest to help you provide tailored therapy is just beginning.

Making science personal.

MG50961 0308 PRINTED IN USA © 2008, ELI LILLY AND COMPANY. ALL RIGHTS RESERVED.

Lilly
Answers That Matter.

SCIENTIFIC PROGRAMME

Time	Auditorium
16.30-17.30	Keynote Lecture Chair: A. von Deimling (Heidelberg, Germany) Clinical relevance of glioma typing and grading according to the WHO, J. M. Kros, (Rotterdam, The Netherlands) Followed by
17.30-18.00	Room/Sala F EANO General Assembly
Time	Auditorium
18.10-19.10	Satellite Symposium Ark Therapeutics (from 17.40-18.10 Cocktail) GBM tumours: therapeutic evolution Chair: M. Westphal Welcome, Introduction & Agenda, <i>M. Westphal</i> High-Grade Glioma: Current Therapies, <i>M. van den Bent</i> High-Grade Glioma: Gene Therapy, <i>Z. Ram</i> Sitimagene Ceradenovec: ASPECT Study, <i>M. Westphal</i> Q&A Session and Close

20.30-23.00 EANO VIII Evening

MARQUES DE COMILLAS - DRASSANES REIALS DE BARCELONA
(“Las Drassanes” - originally the royal shipyards)

Contribution per ticket (including music, food and beverages): EUR 70.-

Please note that seats are limited and advance registration is mandatory in order to receive a ticket!

Limited Attendance!

SATURDAY, SEPTEMBER 13

Neuro-Oncology

receives ISI Impact Factor of

5.806

Neuro-Oncology's Impact Factor of 5.806 for 2007—up from 4.939 for 2006—places the journal 6th among all ranked clinical neurology journals and 16th among all ranked oncology journals. The new ranking confirms *Neuro-Oncology's* reputation as the leading journal in the field of neuro-oncology.

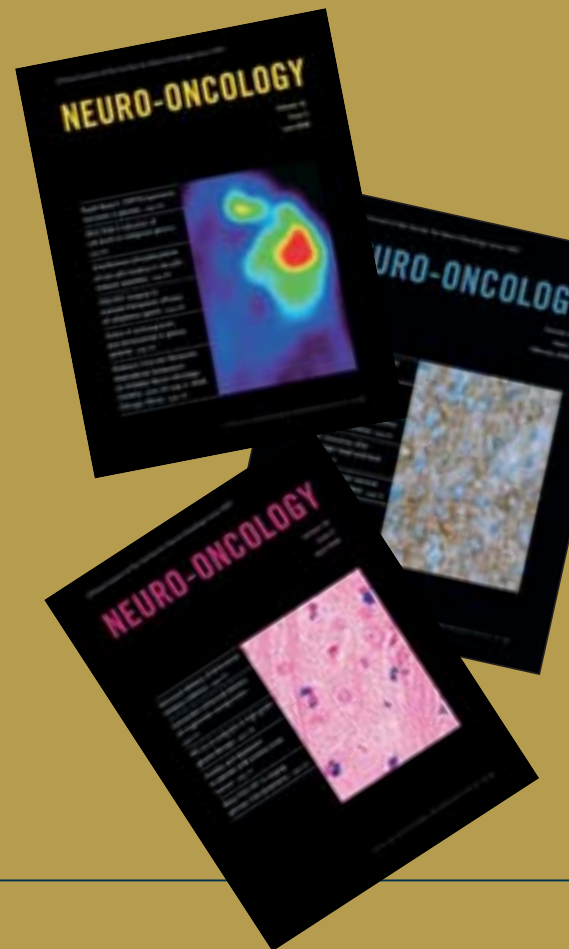

Free online access to current and back issues is included with print subscriptions.

Online access includes the following features:

- fully searchable text
- reference linking
- table-of-contents alerts
- publication before print

*The official journal of the
European Association for Neuro-Oncology,
the Japan Society for Neuro-Oncology, and
the Society for Neuro-Oncology*

DUKE
UNIVERSITY PRESS

SCIENTIFIC PROGRAMME

Time	Auditorium
09.00- 11.00	Plenary Session Neurological complications of cancer Chair: J. Dalmau (Philadelphia, USA) The paraneoplastic encephalitides: immunological diversity and treatment approach, J. Dalmau, (Philadelphia, USA) The long term neurological consequences of paediatric brain tumours, C. Kennedy (Southampton, UK) Neurological complications of new cancer therapies, J. Rees (London, UK)
11.00- 11.30	Coffee Break
11.30- 12.00	Special Lecture Chair: F. Graus (Barcelona, Spain) Ongoing clinical trials in brain tumors, M. van den Bent (Rotterdam, The Netherlands)
12.00- 13.00	Keynote Lecture Chair: R. Grant (Edinburgh, UK) How not to misinterpret data from clinical trials, C. Counsell, (Aberdeen, UK)
13.00- 13.30	Communication Awards & Closing Remarks

SUNDAY, SEPTEMBER 14



Una vocación especial por atenderle.

Cada vez que elige Iberia tiene a su disposición una de las flotas más modernas de Europa y más de 25.000 profesionales que trabajan para hacer de su vuelo una experiencia placentera. Disfrute de una atención personalizada de alta calidad, con una amplia gama de servicios creados para que nada le falte a la hora de volar. Y gracias a nuestra alianza con **oneworld**, ahora tiene muchos más destinos a su alcance, siempre con las mejores conexiones. Todo pensado para que sólo tenga una opción: la mejor.

It's our pleasure to serve you.

When you opt for Iberia you are choosing one of Europe's most modern fleets with over 25,000 people working hard to make sure your flight is as pleasant an experience as possible. Enjoy our first-rate individual attention and wide range of services, carefully designed to ensure all of your personal needs are taken care of throughout your journey. And thanks to our membership of the **oneworld** alliance, we can now offer you even more destinations worldwide, always with the best transfer connections. Because we continually aim to exceed your expectations you will soon realise there is really only one choice... Iberia.

IBERIA 

iberia.com



More than 400 airport lounges across the globe: **oneworld**

Más de 400 Salas VIP en aeropuertos de todo el mundo: **oneworld**

As per date of printing.

Thursday, September 11, 2008

10.00-16.30 HealthAgent Workshop

Room/Sala F

Friday, September 12, 2008

13.30-15.00 Neuro-Oncology Editorial Board Meeting

Room K2

18.00-20.00 LGG meeting, 30 Persons

Room/Sala J

18.00-20.00 CI-Perinoms Study: update and investigators' meeting

Room/Sala F

Saturday, September 13, 2008

17.30-18.00 EANO General Assembly

Room/Sala F

Corporate Satellite Symposia open to all participants

Thursday, September 11, 2008

18.00-19.00 Satellite Symposium Merck Serono

Room/Sala J

Cilengitide – the first integrin inhibitor in the treatment of glioblastoma multiforme

Chair: M. van den Bent (The Netherlands), M. Weller (Switzerland)

18.00-18.05 Welcome and Introduction

M. Weller, Switzerland

18.05-18.20 Current treatment methods in glioblastoma multiforme

D. Reardon, USA

18.20-18.35 Cilengitide – a first-in-class integrin inhibitor

J. C. Tonn, Germany

18.35-18.50 CENTRIC – a phase III study of cilengitide in GBM

R. Stupp, Switzerland

18.50-19.00 Discussion and closing remarks

M. van den Bent, NL

Friday, September 12, 2008

18.00-19.30 Satellite Symposium Schering Plough

Auditorium

Neuro-Oncology 2008: Are we having more answers or more questions?

Chair: M. van den Bent (The Netherlands), D. den Hoed (The Netherlands)

18.00-18.05 Welcome and Introductions

M. van den Bent, NL

18.05-18.25 Presentation of NOA-4: Randomized Phase III Study of Sequential Radiochemotherapy of Anaplastic Glioma with PCV or Temozolomide

W. Wick, Germany

18.25-18.45 Pathology Review in Clinical Trials: Mandatory or Many-Headed Monster?

M. van den Bent, NL

18.45-19.05 The Troublesome Diagnosis of Anaplastic (WHO Grade III) Glioma: The EORTC Experience

J. M. Kros, NL

19.05-19.25 Applying MGMT Assessment: A Critical Assessment of Various Methods

M. Weller, Switzerland

19.25-19.30 Question and Answer Session
Faculty Panel

Saturday, September 13, 2008

17.40-18.10 Cocktail

18.10-19.10 Satellite Symposium Ark Therapeutics

Auditorium

"GBM tumours: therapeutic evolution"

Chair: M. Westphal (Germany)

18.10-18.15 Chairman's Welcome, Introduction & Agenda

M. Westphal, Germany

18.15-18.30 High-Grade Glioma: Current Therapies

M. van den Bent, NL

18.30-18.45 High-Grade Glioma: Gene Therapy

Z. Ram, Israel

18.45-19.00 Sitimagene Ceradenovec: ASPECT Study

M. Westphal, Germany

19.00-19.10 Q&A Session and Close

POSTER TOPICS

P01 Pediatric brain tumors	P001–P010
P02 Primary brain tumors: Miscellanea	P011–P028
P03 Neurosurgical topics.....	P029–P044
P04 Meningiomas	P045–P054
P05 Malignant glioma: second line therapies	P055–P065
P06 Neuroimaging	P066–P084
P07 Predictive biomolecular markers (I)	P085–P100
P08 Stem cells	P101–P111
P09 Cell biology and signaling	P112–P133
P10 CNS metastases	P134–P145
P11 Non-metastatic complications.....	P146–P156
P12 Quality of life / Palliative care	P157–P170
P13 Malignant gliomas: up-front treatments	P171–P182
P14 Predictive biomolecular markers (II)	P183–P199
P15 Tumoral immunology	P200–P205
P16 Neuropathology.....	P206–P219
P17 Epidemiology/clinical series and case reports	P220–P278

SCIENTIFIC INFORMATION

Posters will be on display from **Friday, September 12 (08.00 hrs) to Saturday, September 13 (18.30 hrs)**.

Poster mounting and removal:

For posters presented on Friday, September 12:

Mounting: Friday, September 12, 07.30 – 09.00

Removal: Friday, September 12, 18.00 – 19.00

For poster presented on Saturday, September 13:

Mounting: Saturday, September 13, 07.30 – 09.00

Removal: Saturday, September 13, 17.30 – 18.30

Please note that posters that are not removed by this time will be removed by conference staff and will not be stored or returned to the authors after the meeting.

You will find your **poster board number** in the author index at the end of the abstract book.

Presence at Posters

In order to enable discussion and interaction with other participants, we request you or another member of your group to be at your poster board between:

14.30 and 15.30 hrs on Friday, September 12 for the following posters topics:

Cell biology and signalling

Malignant glioma: second line therapies

Meningiomas

Neuroimaging

Neurosurgical topics

Pediatric brain tumors

Predictive biomolecular markers (I)

Primary brain tumors: Miscellanea

Stem cells

or

14.00 and 15.00 hrs on Saturday, September 13 for the following posters topics:

CNS metastases

Epidemiology/clinical series and case reports

Malignant gliomas: up-front treatments

Neuropathology

Non-metastatic complications

Predictive biomolecular markers (II)

Quality of life / Palliative care

Tumoral immunology

If this is not possible, please leave a note on your poster board indicating the times when you will be present.

Programme Changes

The organisers cannot assume any liability for changes in the programme due to external or unforeseen circumstances.

Projection and Technical Setting

- All rooms will be equipped with data-projection (no slides).
- It is essential that you load and view your presentation in the slide preview room preferably 6 hours before your talk, but no later than 2 hours in advance.
- The lecture rooms are exclusively equipped with Windows-PCs (no Macintosh machines). In case you absolutely need to use your own laptop or notebook, please contact the preview center well in advance of your talk.
- Please bring a USB-stick or CD-ROM, all formatted for Windows® (PC). You may want to carry a second disk/CD as a back-up in case there is any insoluble technical problem.
- File Format: Microsoft® Power Point™ presentation formatted for Windows® (PC) only. (Operating system: Windows XP®)
- Preferred Resolution: XGA (1024 x 768 pixel)

Thursday, September 11, 2008, 19.00

Welcome Reception in the beautiful garden of the Rey Juan Carlos I Hotel

You will be served delicious tapas and local beverages while enjoying the beautiful atmosphere of the Torre Melina gardens, amongst the native pines, palm trees and a peaceful pond. The garden is located half way between the hotel Rey Juan Carlos I and the EANO VIII Congress venue, the Palacio de Congresos.

Dress code: casual smart

Free for registered participants and accompanying persons.

Please note that advance registration is mandatory in order to receive a ticket!

Limited attendance!

Saturday, September 13, 2008, 20.30

EANO VIII Evening

MARQUES DE COMILLAS - DRASSANES REIALS DE BARCELONA

The venue is located at the Ramblas on Barcelona's seafront near Port Vell. "Las Drassanes" – originally the royal shipyards – date back to the 13th century and were given to the City of Barcelona at the end of the Civil War. Today this is the largest and best preserved example of a medieval shipyard in the world. Part of the building (Reials Drassanes) houses the Maritime Museum with some fascinating exhibits, special effects and replicas of old ships. The dining hall (Marqués de Comillas) is a huge room with impressive Gothic arches.

Enjoy the exceptional atmosphere, excellent food and beverages.

Dress code: casual smart

Contribution per ticket (including music, food and beverages): EUR 70.–

Please note that seats are limited and advance registration is mandatory in order to receive a ticket!

Limited Attendance!

ADDRESS

Av. de les Drassanes s/n, 08001 Barcelona

www.museumaritimbarcelona.org

HOW TO GET TO THE MUSEUM

Public transport

Metro line 3 / Drassanes station

(Portal de Santa Madrona exit)

Bus lines 14, 18, 36, 38, 57, 59, 64 and 91

Car parks: Drassanes and Moll de la Fusta

Coach park: Carrer Josep Carner

Please note: Space is limited, please check at the registration desk if tickets are still available. Tickets will be checked at the entrance.

GENERAL INFORMATION

Badges

Participants should collect name badges from the conference registration desks. Since only registered participants will be permitted to attend the scientific sessions, the exhibition and poster areas, you are kindly asked to wear your badge when entering the congress venue. Accompanying persons and exhibitors will also receive badges to allow access to the respective areas.

Lost badges can be replaced at the registration desk. However, a handling fee of EURO 30.- will be charged.

Bank services - Money matters

Banks are open from 8.30 – 14.00 hrs, Monday to Friday. Some banks are also open on Thursday afternoons until 20.00 hrs or on Saturdays from 8.30 13.30 hrs. A bank is always open at Sants Railway Station. There are multiple bank machines (ATMs) open 24 hours a day throughout the city which accept all major international bankcards. The official currency of Spain is the Euro (€). Major credit cards are widely accepted, but please always check beforehand.

Barcelona

Barcelona is one of the historic harbours of the Mare Mediterraneum. Located on the coast and bounded by the Collserola ridge and rivers Besós and Llobregat, it is the capital of Catalonia and the second biggest city of Spain. The city is less than 150 km from the Pyrenees. Barcelona's location on the shores of the Mediterranean gives it a warm, welcoming climate and pleasant temperatures all year round.

Barcelona is a city of renowned architectural interest, from its Roman walls to the new urban planning schemes of the eighties. Particular highlights are its modernista heritage and contemporary architecture. The city offers many cultural activities, such as visits to museums and exhibitions, drama performances and other shows.

In Barcelona, as in the rest of Catalonia, there are two official languages: Catalan, the language of the region, and Spanish, the official language of Spain.

The daytime temperature in September is usually warm with an average of 20°C.

For more information about Barcelona, please see: www.bcn.es.

Cancellations and Refunds

Notice of cancellation must be made in writing, by registered letter or fax to the congress office. Registration fees will be refunded as follows:

Written cancellation received:

- by 31 July 2008: 75% refund

- after 31 July 2008: no refund

The date of the postmark or fax ID will be considered for refund policy. Please indicate your preferred method of reimbursement (cheque or bank transfer, incl. account number) on your written cancellation. All refunds will be made after the congress.

Car Parking

Participants may park their car in the parking lot of the Rey Juan Carlos Hotel.

Certificate of Attendance

Confirmations of attendance will be issued at the registration desk.

Climate

The temperature in September is warm and averages around 20 degrees celsius (68 degrees Fahrenheit). Evenings are cooler and light jackets or sweaters are recommended.

Cloakroom and Luggage

A cloakroom and luggage storage facilities are available in the congress venue.

GENERAL INFORMATION

CME credits

The EANO has applied for credits at the European Accreditation Council for Continuing Medical Education, Institution of the UEMS. The number of credits will figure on the respective confirmation, which will be sent after the meeting. The rules of the EACCME state that participants are kindly asked to fill in the feedback form included in the conference bag. It can be returned to the registration desk.



Participants applying for credits will have to have their badge scanned daily at the CME desk in the registration area before entering the conference.

Postgraduate Course: This activity has been accredited with 0,8 CME credits by the Catalan Council of Continuing Medical Education – Spanish Commission on Continuing Education of Health Professions equivalent to 6 learning hours.

Coffee Breaks

During the session breaks refreshments (coffee, tea, and water) will be served free of charge to participants wearing name badges.

Congress venue

PALAU DE CONGRESSOS DE CATALUNYA, Av. Diagonal, 661-671 08028 Barcelona, Spain, www.pcongresos.com

The EANO VIII is held in the Catalonia Palace of Congresses, located in the financial and business centre of Barcelona, on the "Diagonal", Barcelona's main avenue with a splendid panoramic view over the city and the sea. It has easy access to the airport and to the motorways to Madrid, France and the Mediterranean Coast. This complex is set in one of the most beautiful gardens of the city. The Catalonia Palace of Congresses is a modern structure comprising a large number of rooms, restaurants, business centres and offices, all of which are equipped with the highest levels of technology and maximum comfort.

Currency

The official currency of Spain is the Euro (€). 1 EUR = 1,54 USD = 0,78 GBP = 162 JPY = 1,62 CHF as per date of printing.

Drinking water

Tap water in Spain is purified so it is suitable for drinking. Most people, however, prefer to drink bottled water because it tastes better and is moderately priced.

Eating Out in Barcelona

In Barcelona, as elsewhere in Spain, mealtimes are usually later than in the rest of Europe. Here, at home many people have lunch between 14.00 and 15.00 hrs and dinner between 21.00 and 22.00 hrs. However, restaurant lunchtime hours are adapted to working hours and to visitors. Lunch is normally served from 13.00 to 15.00 hrs, and dinner between 21.00 and 23.30 hrs. But there are many restaurants that have more flexible opening hours, not to mention the innumerable "tapas" bars and bistros that stay open all day.

Electricity Supply

220V - 50Hz AC. Adaptors can be obtained from your hotel reception or electronics stores.

Exhibition Opening Hours

Friday, September 12, 2008	08.30 – 18.00
Saturday, September 13, 2008	08.30 – 18.00

GSM cell phone roaming

GSM cell/mobile phone roaming is available without any problems for all major international providers. It is advisable to ask your provider beforehand which roaming company in Spain offers the cheapest tariffs.

GENERAL INFORMATION

Insurance

In registering for the EANO 2008 participants agree that neither the organising committee nor the congress office assume any liability whatsoever. Participants are requested to make their own arrangements for health and travel insurance.

Internet

An internet café as well as a WIFI access will be available on level -1 – please follow the signage or ask at the registration desk. You may also find small Internet cafés throughout the city.

Language

The official language of the congress will be English (no simultaneous translation). Catalan and Spanish are the official languages in Barcelona.

Lunch and Refreshments

Lunch tickets for lunch boxes for Thursday, Friday and Saturday are included in the registration fee but **had to be pre-ordered on the registration form - they cannot be purchased on site.**

Medical care

The Spanish National Health Service may be used by all persons from European Union countries who have the E111 Form or EHICard. This form should be obtained at the health service or post office of the visitor's home country before travelling to Spain. It is advisable for participants from countries outside the European Union to take out medical insurance before reaching Spain since they will be charged for access to the national health system.

Message Board

A Message Board is available in the Registration Area.

Pharmacies

Pharmacies are easy to identify thanks to the green cross displayed outside. Medicines that do not require a medical prescription may be purchased directly over the counter. If you need advice, do not hesitate to ask the pharmacist. If you usually take medication, it is advisable to bring a sufficient amount with you for your trip. There are duty pharmacies open 24 hours a day in most city districts. Outside the pharmacies there is a list of the nearest duty pharmacies.

Poster Removal

The organisers cannot assume any liability for loss or damage of posters displayed in the poster area. Posters that are not removed after the end of the poster viewing on Saturday, September 13, 2008, 18.30, *will be removed by staff and will not be stored or forwarded to the author after the meeting.*

Preview Room

Equipment for a final check of the sequence of your presentation is available in the preview room. All presenters should bring their electronic presentation to the preview room preferably in the morning of the day of the talk, but no later than 2 hours before the start of the session.

Registration Desk opening hours

Thursday, September 11, 2008	08.30 – 19.00 hrs
Friday, September 12, 2008	07.00 – 19.30 hrs
Saturday, September 13, 2008	07.30 – 19.10 hrs
Sunday, September 14, 2008	08.30 – 13.30 hrs

GENERAL INFORMATION

Safety - Crime

Visitor safety is generally adequate. As in any other major European city, you can walk everywhere using common sense. Pick pocketing in heavily frequented tourist zones or in public transport lines might be a concern.

Unfortunately experience has shown that some basic precautionary measures should always be kept in mind in any city:

- Do not carry important items like flight tickets, passports etc. with you when visiting the conference or strolling through the city. Leave them in the hotel safe during your stay. Rather, carry a photocopy of your passport or an identity card with you.
- Try not to carry all documents, money, credit cards and other essential items and valuables in *one* bag. If it gets lost or stolen, everything will be gone and might be difficult to replace on short notice, especially passports and visa to return to your country of residence.
- Take off your name badge when leaving the conference center.

Shops

Shops in Barcelona open between 9.00 and 10.00 hrs, and most of them close at lunchtime, at about 13.30 hrs. They reopen in the afternoon between 16.00 and 17.00 hrs and do not close until 20.00 or 20.30 hrs. Department stores and hypermarkets do not close for lunch. All retailers, including small shops and department stores, are open on Saturdays and closed on Sundays, except for a few establishments with special permits.

Smoking Policy

The EANO 2008 is a "No-smoking-Conference". Please note that smoking is banned from all public buildings. Restaurants and bars may, depending on size, be declared either as "smoking" or "no-smoking" locations or have separate areas and ventilation systems.

Staff

Should you have any questions, congress staff will be pleased to help you. Please contact the registration desk.

Taxis

Barcelona has a fleet of 11.000 taxis which can be easily identified by their yellow and black livery. A green light on top of the taxi indicates its availability.

Technical Exhibition Organiser

Medizinische Ausstellungs- und Werbegesellschaft (MAW)

Ms. May-Britt Ernst

Freyung 6, A-1010 Vienna, Austria

T : +43 1 536 63-75, M: +43/664/105 20 18

F : +43 1 535 60 16

may-britt.ernst@media.co.at / maw@media.co.at

Tipping

Tips are not obligatory in Spain, although people usually leave them at restaurants (a maximum of 10% of the total amount of the bill). Hotel and airport porters will accept tips, depending on the luggage.

Travelling - Accessibility

The fastest and cheapest way to move around Barcelona is by public transport.

The easiest to use is the **metro** – with 5 different lines (identifiable by different colours) running from 5AM to midnight on Mondays-Thursdays as well as Sundays and from 5.00 to 2.00 hrs on Fridays, Saturdays and holidays. A one-way fare costs around € 1,30. Tickets are checked before boarding and it may be a good idea to get a deal using multiple-trip tickets.

GENERAL INFORMATION

Barcelona's **suburban train service**, the FCG, Ferrocarrils de la Generalitat de Catalunya, is also a wise travel option with 2 lines in Barcelona and 4 others going to towns close by. Trains run from 5.45 to 0.05 hrs on Mondays through Thursdays, from 5.50 to 2.15 hrs on Fridays and Saturdays and from 5.50 to 0.02 hrs on Sundays. The fare is also around 1€.

The **bus**, while being a much slower form of transportation (due to traffic at rush hour), is not a bad option considering the city's extensive bus network (over 70 lines). It is also a great way of seeing the city. Different routes have different schedules and fares are also around € 1.-.

A **taxi** is the most comfortable way of getting around the city but also the most expensive. Identifiable by their black and yellow colouring, taxis show a green light when available. Prices must be displayed inside the cab and meters (which are compulsory in all cabs) will indicate the fare. A fun and novel alternative includes **bikes**, which are ideal for touring the city at one's own leisure. These can be hired at Scenic: www.scenic.es.

Travelling to the congress venue by public transportation

By metro to the Palau de Congressos de Catalunya:

Line 3 (green line) goes directly to the Palau de Congressos de Catalunya. Get off at the Zona Universitaria stop (2 minutes walking distance from the congress venue).

From the airport: Barcelona Airport El Prat (11 km)

- **By car/taxi:** Coming out of the airport take the B-17, direction Barcelona (5 kilometres), follow the signs for B-20, Ronda de Dalt (blue). Once you are on the B-20, continue straight on until you see the exit sign for "salida" 11 (Les Corts - Zona Universitaria). From this point on you can see the hotel. Continue for 200 meters on the right lane of the Avenida Diagonal and take the second street to the right which leads you directly to the Hotel. (Overall duration of trip: approximately 15 minutes.)

- **By train/metro:** The train station is located right next to the Airport. Take the train as far as Sants Estació, the city's main train station. Once you arrive, take the subway train (Metro), Line 3 (green line) and get off at the Zona Universitaria stop (2 minutes walking distance from the Hotel). (Overall duration of trip: approximately 40 minutes.)

- **By Aerobus:** The aerobus, express airport bus service, links the airport with the main areas of interest in the city. The terminal for the Aerobus is just in front of airport itself and it stops at every terminal. In order to get to the Hotel you must get off at the Plaza España stop (first stop within the city). Take the subway Line 3 from here (green line) and get off at the Zona Universitaria station (2 minutes walk from the Hotel). (Overall duration of trip: approximately 35 minutes.)

DISTANCES

20 minutes from the heart of the city.

10 kilometres from the airport (15 minutes by car)

2 minutes walk to the nearest subway station (Line 3, green), bus and tram.

3 kilometres from the city's main train station.

V.A.T.

A value-added tax (V.A.T.) of 7% (food) to 16% (other items) is applied to all products and services. In most cases it is included in the price. Whenever it is not included, however, it will be clearly specified.

REGISTRATION FEES

Registration Fees in EUROS

If you wish to attend postgraduate courses, please mark this on the form; there is limited space, so please pre-register well in advance! Registration for the meeting does not include registration for the courses.

For the EANO VIII Meeting September 12-14, 2008

Payment received	by 31 May 2008	by 22 August 2008	after 22 August 2008 and onsite
Regular participants/members	EUR 350.-	EUR 420.-	EUR 470.-
Regular participants/non members	EUR 550.-	EUR 620.-	EUR 670.-
Nurses, Trainees ¹	EUR 200.-	EUR 200.-	EUR 350.-
Day ticket/members			EUR 250.-
Day ticket/non members			EUR 350.-
Accompanying persons	EUR 40.-	EUR 60.-	EUR 60.-

¹ (applies to trainees only if younger than 35 years; please provide a copy of an ID together with your registration).

What is covered by the registration fee?

Participants:

Admission to all scientific sessions, exhibition and welcome reception
Abstract book and programme
Coffee breaks
Lunch boxes on 2 days (Friday and Saturday)

Accompanying persons:

Admission to the welcome reception
(No admission to lectures)

For the EANO VIII Postgraduate courses September 11, 2008

Registration fee: EUR 150.-

Includes: admission to courses of your choice, syllabus, coffee breaks and lunch box for 1 day (Thursday)

Payment of registration fees

to be made in advance in EURO by:

- **Bank transfer** to bank account "EANO 2008" No. 28036580398, Bank/Routing code 20111, SWIFT/BIC: **GIBAATWW**, at the Erste Bank, Alser Strasse 23, 1080 Vienna, Austria, IBAN **AT022011128036580398** – to avoid bank charges, please use the IBAN within the EU. Payments are to be made free of charge to the beneficiary. Any bank charges will be collected on site. Clearly state the participant's name(s), as indicated on the registration form.
- **Cheque.** Bank cheques free of charge to the beneficiary, must be payable to "EANO 2008" c/o Vienna Medical Academy. Alser Strasse 4, A-1090 Vienna, Austria.
- **Credit Cards:** Diners Club, Mastercard and Visa (Amex cannot be accepted).

REGISTRATION FEES

Please note

The reduced registration fee is only applicable if it is credited to the congress account before the deadline. Registration before 31 May 2008 without making an actual payment is not sufficient for a reduced fee.

Pre-registration without payment of the registration fee is possible. The full fee is to be paid at the registration desk (Credit card or cash in EURO).

After receipt of your registration and payment, you will receive a written **Confirmation of registration** by mail.

After 22 August 2008, pre-registration will be closed, but you may register at the "On-site registration desk".

Cancellations and refunds

Notice of cancellation must be made in writing, by registered letter or fax, to the congress office (please find our address under "organising offices")

Registration fees will be refunded as follows:

Written cancellation received: – by 31 July 2008: 75% refund
– after 31 July 2008: no refund

The date of the postmark or fax ID will be considered for refund policy. Please indicate your preferred method of reimbursement (cheque or bank transfer, incl. account number) on your written cancellation. All refunds will be made after the congress.

REGISTRATION ONSITE

Registration for both the postgraduate courses and the EANO 2008 conference is possible on Thursday, September 11, from 8.00 to 19.00 hrs.

Thereafter the registration desk will be open throughout congress hours.

EXHIBITORS STANDING

EXHIBITORS STANDING

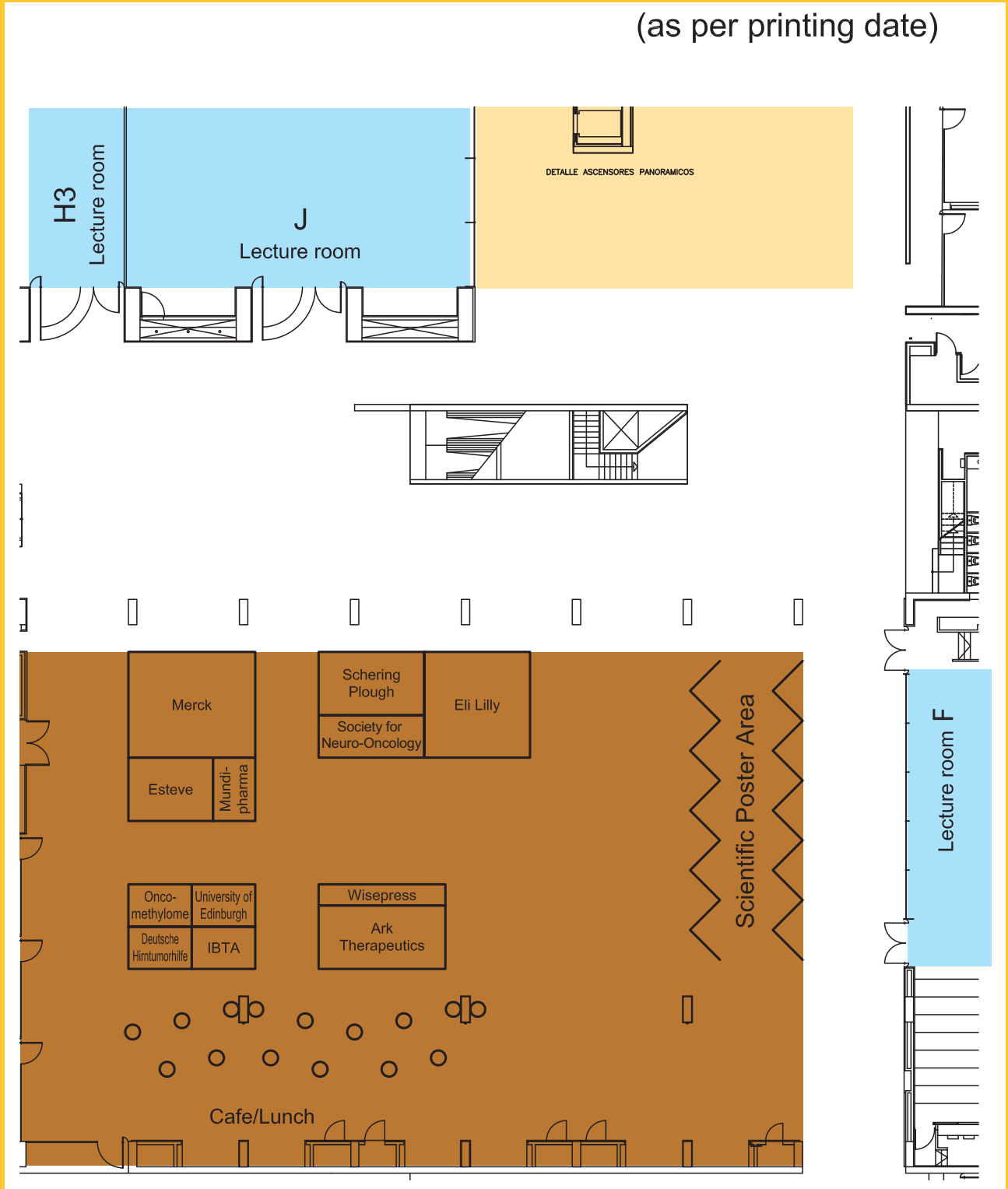

EXHIBITORS LISTING

The European Association of NeuroOncology gratefully acknowledges the support of the following institutions, companies and organisations (list correct as per date of printing):

in Alphabetical Order

ARK THERAPEUTICS, London, United Kingdom
DEUTSCHE HIRNTUMORHILFE, Leipzig, Germany
ELI LILLY, Indianapolis, United States
IBTA, Tadworth, United Kingdom
LABORATORIOS ESTEVE, Barcelona, Spain
MERCK, Darmstadt, Germany
MUNDIPHARMA INTERNATIONAL, Cambridge, United Kingdom
ONCOMETHYLOME, Leuven, Belgium
SCHERING PLOUGH, Kenilworth, United States
SOCIETY FOR NEURO-ONKOLOGY, Houston, United States
UNIVERSITY OF EDINBURGH, Edinburgh, United Kingdom
WISEPRESS, London, United Kingdom

Ark Therapeutics

Website www.arktherapeutics.com

Deutsche Hirntumorhilfe

Website www.hirntumorhilfe.de

Eli Lilly

Website www.lilly.com

International Brain Tumor Alliance – IBTA

Website www.theibta.org

Laboratorios Esteve

Website www.esteve.es

Merck

Website www.merck.de

Mundipharma

Website www.mundipharma.co.uk

Oncomethylome

Website www.oncomethylome.com

Schering Plough

Website www.schering-plough.com

Society for Neuro-Oncology

Website www.soc-neuro-onc.org

University of Edinburgh

Website www.healthagents.net

Wisepress

Website www.wisepress.com

*The EUROPEAN
ASSOCIATION of
NEUROONCOLOGY*

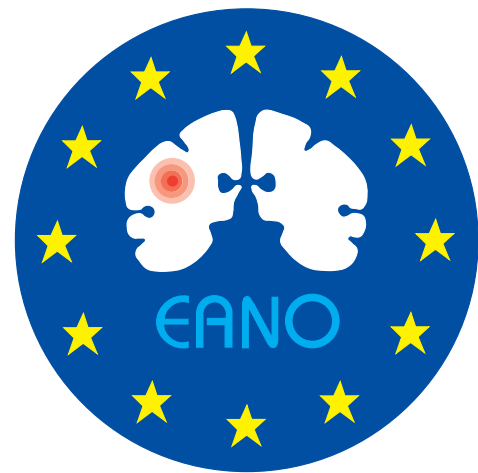

9th MEETING

See you! 2010

September 16-19

MAASTRICHT

MAASTRICHT EXHIBITION & CONGRESS CENTRE (MECC)

www.eano.eu

Ark Therapeutics Satellite Symposium

GBM TUMOURS:

THERAPEUTIC EVOLUTION

Saturday 13th September 2008

18:10 – 19:10

Main Auditorium, Level 0



Ark Therapeutics are delighted to invite you to attend a satellite symposium entitled “GBM tumours: therapeutic evolution”, presented by an international panel of renowned experts. The aim of this symposium, chaired by Professor Manfred Westphal (Germany), is to provide a forum to review the established treatment options for glioblastoma multiforme (GBM) tumours. The audience will also be brought up to date on the recently completed clinical programmes that may affect future therapeutic choices.

Please join us, and the members of our distinguished international faculty, for what promises to be an educational and informative session that will provide a platform to discuss both the new and established treatment options for glioblastoma multiforme tumours.

Time	Session
18:10 – 18:15	Chairman's Welcome, Introduction & Agenda <i>Professor Manfred Westphal</i> <i>University Hospital, Hamburg, Germany</i>
18:15 – 18:30	High-Grade Glioma: Current Therapies <i>Professor Martin van den Bent</i> <i>Eramus University Hospital,</i> <i>Rotterdam, The Netherlands</i>
18:30 – 18:45	High-Grade Glioma: Gene Therapy <i>Professor Zvi Ram</i> <i>Tel Aviv Medical Centre, Tel Aviv, Israel</i>
18:45 – 19:00	Sitimagene Ceradenovec: ASPECT Study <i>Professor Manfred Westphal</i> <i>University Hospital, Hamburg, Germany</i>
19:00 – 19:10	Q&A Session and Close

For all of your TEMODAL® patients

Simplify their treatment...

Introducing two new dosage strengths



Why Design Two New Capsules?

New 140-mg and 180-mg capsules allow for fewer capsules, less complicated dosing regimen in many patients

- New strengths were developed based on:
 - the most common dosage prescribed
 - the median BSA of 1.8 m²

Because Simpler Treatment Regimens Are Easier to Follow

- Potentially fewer capsules to take
- Greater dosing flexibility
- Greater patient convenience
- Same precise dosing



For Example...



50 year old male

- 5 feet 10 inches (178 cm)
- 160 lbs (73 kg)
- BSA = 1.9

Dose at 75 mg/m²

140 mg =



Dose at 200 mg/m²

380 mg =



TEMODAL® is indicated for the treatment of patients with newly diagnosed glioblastoma multiforme concomitantly with radiotherapy and subsequently as monotherapy treatment. TEMODAL® is also indicated for patients with malignant glioma, such as glioblastoma multiforme or anaplastic astrocytoma, showing recurrence or progression after standard therapy.

Temodal®
temozolomide
capsules

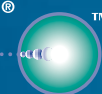

Improves Survival!

Reference: 1. Temodal Summary of Product Characteristics.

See full prescribing information available at the booth.

Schering-Plough

SP Europe 73, rue de Stalle, Bruxelles, Belgium is the market authorisation holder in the European Union.
Copyright © 2008, Schering-Plough Corporation, Kenilworth, NJ 07033. All rights reserved. EANO-1 TEM-Sept08